

Legend:

Easements to be removed
C.A = Crown Allotment

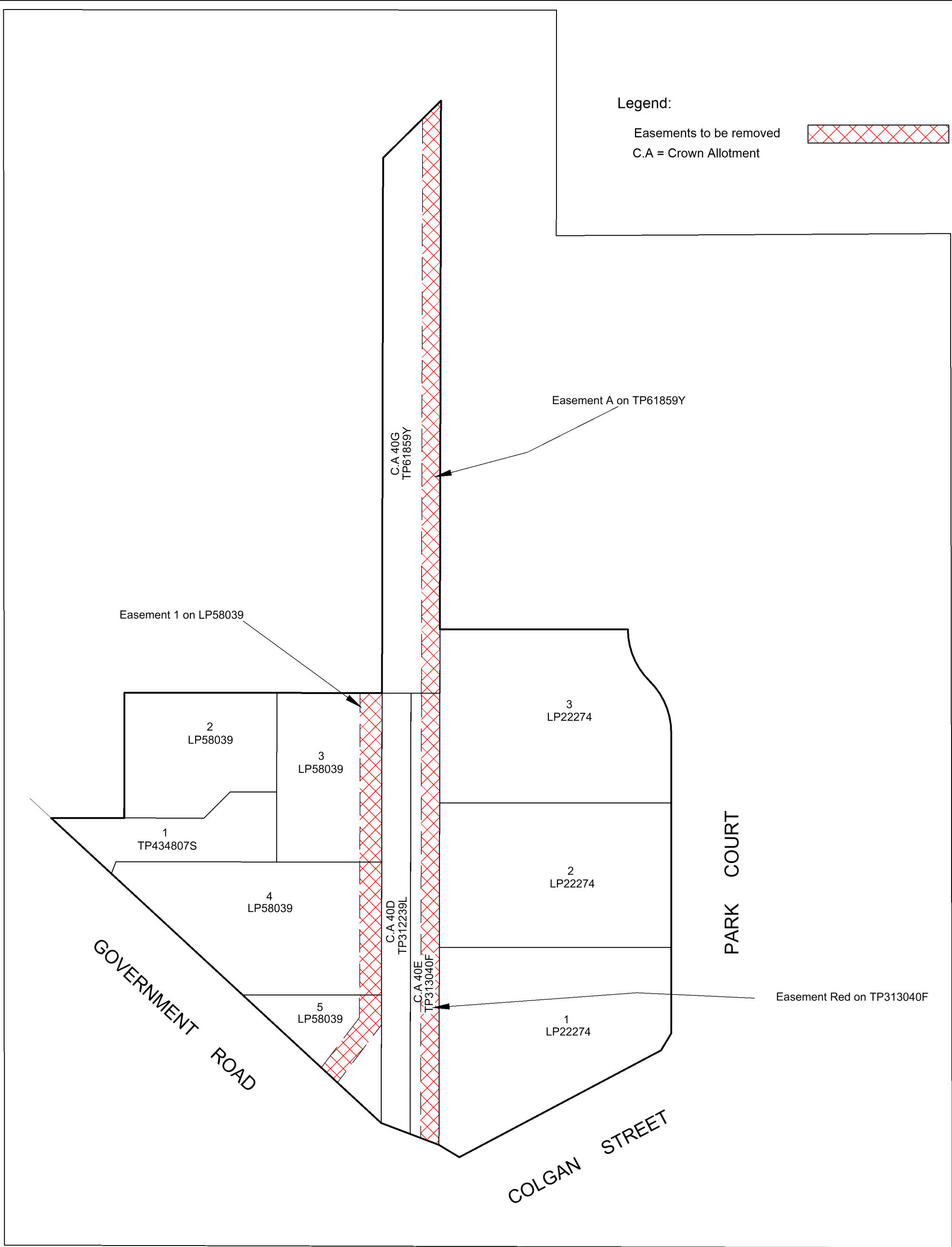

REVISION	DATE	ZONE

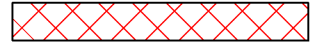
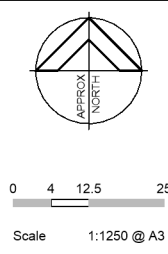

Chris Smith & ASSOCIATES PTY LTD
 CIVIL ENGINEERS LAND SURVEYORS
 URBAN & REGIONAL PLANNERS PROJECT MANAGERS
 LEVEL 1 / 135 FRYERS STREET, SHEPPARTON, VIC. 3630
 PH (03) 5820 7700 FAX (03) 5822 4878 www.csmith.com.au

Designed Dylan Stevens 23 February 2024
 Drawn Dylan Stevens 23 February 2024
 Checked Gary Steigenberger 23 February 2024
 Approved

Plan of Removal of Easements
 2-6 Colgan Street
 Cobram, VIC, 3644

Drawing No. 24047/01 Rev. 0
 Sheet No. 1 of 1 2404701v0.dwg A3

© Chris Smith & Associates ABN 14 627 882 064
 THIS DOCUMENT IS COPYRIGHT AND MAY ONLY BE USED FOR THE PURPOSE FOR WHICH IT
 WAS COMMISSIONED. UNAUTHORISED USE PROHIBITED. ALL DIMENSIONS AND LEVELS TO BE
 CHECKED ON THE PROJECT BEFORE COMMENCING ANY WORKS OR SHOP DRAWINGS.
 DRAWINGS NOT TO BE SCALED.