



Imaged Document Cover Sheet

The document following this cover sheet is an imaged document supplied by LANDATA®, Secure Electronic Registries Victoria.

Document Type	Plan
Document Identification	LP041776
Number of Pages (excluding this cover sheet)	1
Document Assembled	27/02/2024 09:10

Copyright and disclaimer notice:

© State of Victoria. This publication is copyright. No part may be reproduced by any process except in accordance with the provisions of the Copyright Act 1968 (Cth) and for the purposes of Section 32 of the Sale of Land Act 1962 or pursuant to a written agreement. The information is only valid at the time and in the form obtained from the LANDATA® System. None of the State of Victoria, LANDATA®, Secure Electronic Registries Victoria Pty Ltd (ABN 86 627 986 396) as trustee for the Secure Electronic Registries Victoria Trust (ABN 83 206 746 897) accept responsibility for any subsequent release, publication or reproduction of the information.

The document is invalid if this cover sheet is removed or altered.

PLAN OF SUBDIVISION
 PART CROWN ALLOTMENT 3 SECTION 20
 TOWNSHIP OF NATHALIA
PARISH OF BARWO
 COUNTY OF MOIRA

LP 41776
 EDITION 1
 PLAN MAY BE LODGED 5/11/57

COLOUR CODE
 R1 & R2 = BROWN

THE LAND COLOURED BROWN
 IS APPROPRIATED OR SET
 APART FOR EASEMENTS OF
 WAY AND DRAINAGE

LENGTHS ARE IN METRES

VOL.3116 FOL.023

DEPTH LIMITATION: 50 FEET

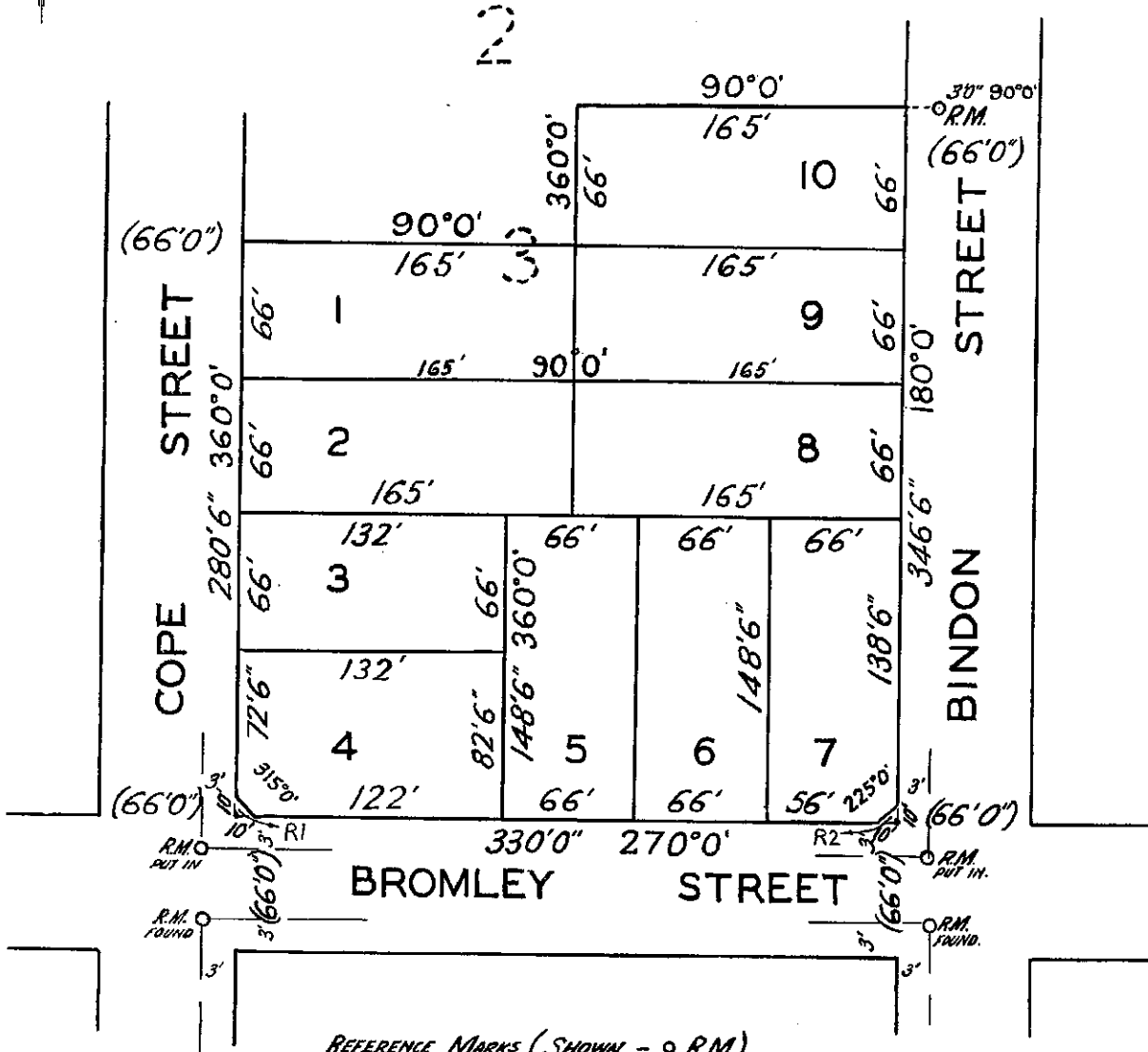

REFERENCE MARKS (SHOWN - o R.M.)
ARE 12" x 3/4" PIPES
FOR DATUM SEE FIELD NOTES.



Copyright State of Victoria. No part of this publication may be reproduced except as permitted by the Copyright Act 1968 (Cth), to comply with a statutory requirement or pursuant to a written agreement. The information is only valid at the time and in the form obtained from the LANDATA REGD TM System. None of the State of Victoria, its agents or contractors, accepts responsibility for any subsequent publication or reproduction of the information.

The Victorian Government acknowledges the Traditional Owners of Victoria and pays respects to their ongoing connection to their Country, History and Culture. The Victorian Government extends this respect to their Elders, past, present and emerging.

**REGISTER SEARCH STATEMENT (Title Search) Transfer of
Land Act 1958**

Page 1 of 1

VOLUME 08235 FOLIO 192

Security no : 124112965130T
Produced 27/02/2024 09:10 AM

LAND DESCRIPTION

Lot 2 on Plan of Subdivision 041776.
PARENT TITLE Volume 03116 Folio 023
Created by instrument A798067 17/08/1959

REGISTERED PROPRIETOR

Estate Fee Simple
Joint Proprietors
WILFRED JOSEPH AGIUS
MARY LOUISE AGIUS both of 2 MITCHELL STREET NATHALIA VIC 3638
AS355034X 16/07/2019

ENCUMBRANCES, CAVEATS AND NOTICES

Any encumbrances created by Section 98 Transfer of Land Act 1958 or Section 24 Subdivision Act 1988 and any other encumbrances shown or entered on the plan or imaged folio set out under DIAGRAM LOCATION below.

DIAGRAM LOCATION

SEE LP041776 FOR FURTHER DETAILS AND BOUNDARIES

ACTIVITY IN THE LAST 125 DAYS

NIL

-----END OF REGISTER SEARCH STATEMENT-----

Additional information: (not part of the Register Search Statement)

Street Address: 21 COPE STREET NATHALIA VIC 3638

DOCUMENT END