

TREEMAP

ARBORICULTURE



Arboricultural Assessment & Report 10, 22 & 38 Brears Road and 4 & 5 Jacqueline Court Yarrowonga

Treemap Arboriculture
PO Box 465, Heidelberg VIC 3084
ABN 20 325 463 261
www.treemap.com.au

August 2023

Prepared for:
Bressan Parks Land Pty Ltd



1 Name and address of consultant

Dean Simonsen (AQF Lvl 7)
Treemap Arboriculture
PO Box 465, Heidelberg, Victoria 3084

2 Instructions

- 2.1 The instructions provided to Treemap Arboriculture on 01/08/23 by Bressan Parks Land Pty Ltd were to provide an Arboricultural assessment and report for trees located on or adjacent to the subject site, the subject sites being;
- 10, 22 & 38 Brears Road, Yarrowonga
 - 4 & 5 Jacqueline Court, Yarrowonga

3 Introduction

- 3.1 The owners of the subject site are making investigations to develop the property. As part of the design process, the owners are undertaking investigations with regards to vegetation located on or near the property. This report examines the arboricultural matters associated with this vegetation.
- 3.2 Under AS4970-2009 (Australian Standard – Protection of trees on development sites), the following report would be defined as a ‘Preliminary assessment and arboricultural report’. The standard indicates that *“This information is to be used by planners, architects and designers, in conjunction with any planning controls and other legislation, to develop the design layout in such a way that trees selected for retention are provided with enough space.”*

4 Key Objectives

- 4.1 To undertake a general assessment of trees located on or near the subject site.
- 4.2 To provide an assessment of the subject trees with respect to their overall condition, structure, safety and suitability for preservation.
- 4.3 To provide recommendations on the suitability of the trees for removal or retention, and provide approved methods of tree protection if retention is recommended.

5 Method

- 5.1 Site and tree inspections were conducted on Thursday 10th & Friday 11th August 2023.
- 5.2 The tree assessment consisted of a visual inspection, which was undertaken with regard to modern arboricultural principles and practices. The assessment did not involve a detailed examination of below ground or internal tree parts. The assessment was undertaken from the ground of the subject site to determine tree condition and species type. Measurements were taken to establish trunk and height dimensions. No tree samples or site soil samples were taken unless specified. Trunk diameters for trees on adjoining properties may be estimated due to site access limitations.

- 5.3 The trees have been allocated a retention value rating which combines tree condition factors with functional and aesthetic characteristics in the context of an urban landscape. The retention or preservation of trees may not depend solely on arboricultural considerations; therefore, the ratings may act as a guide to assist in decisions relating to tree management and retention decisions.
- 5.4 A feature survey plan was provided by the client (Re-establishment Feature & Level Plan prepared by Breese Pitt Dixon, Reference 10894, Revision dated 08/08/23). The assessed trees have been numbered on this plan (Appendix 3) and Tree Protection Zones are provided for specific trees.

6 Observations

- 6.1 The site under review presented as a collection of land parcels including 10, 22 & 38 Brears Road and 4 & 5 Jacqueline Court, Yarrowonga. The site adjoins subdivided residential style properties to the east. Brears Road frontage is located to the west and The Murray Valley Highway frontage is located to the south. The site contained a wide variety of planted native and exotic trees plus a large number of indigenous trees.



- 6.2 Six hundred and fifty-one (651) trees were individually examined as part of the site review. This included 555 trees on the subject site, 65 neighbouring trees and 31 street trees. The detail of each individual tree assessment is provided in table format at Appendix 1. Tree numbers within the assessment table correspond to those provided on the marked-up survey plan (Appendix 3).

- 6.3 A further 345 trees were summarily examined amongst 13 groups. The assessment detail relating to the tree groups is provided below.

No	Species	No of trees	Avg. DBH (cm)	Comment	Retention value	Recommend
Grp 1	<i>Eucalyptus camaldulensis</i>	15	10	Saplings	Low	Neighbour's tree
Grp 2	<i>Schinus areira</i>	5	40		Low	Neighbour's tree
Grp 3	<i>Eucalyptus camaldulensis</i>	60	10		Low	Could be retained
Grp 4	<i>Eucalyptus camaldulensis</i>	50	10		Low	Could be retained
Grp 5	<i>Eucalyptus camaldulensis</i>	10	15		Low	Could be retained
Grp 6	<i>Melaleuca styphelioides</i> & <i>Callistemon</i> sp.	30	15		Low	Remove
Grp 7	<i>Pittosporum tenuifolium</i>	30	5		Low	Neighbour's tree
Grp 8	<i>Pittosporum tenuifolium</i>	30	5		Low	Neighbour's tree
Grp 9	<i>Eucalyptus leucoxylon</i> 'Rosea'	23	25		Low	Could be retained
Grp 10	<i>Melaleuca styphelioides</i> & <i>Callistemon</i> sp.	30	15	Double row	Low	Remove
Grp 11	<i>Eucalyptus leucoxylon</i> 'Rosea'	13	20		Low	Could be retained
Grp 12	<i>Melaleuca styphelioides</i> & <i>Callistemon</i> sp.	30	15	Double row	Low	Neighbour's tree
Grp 13	<i>Syagrus romanzoffiana</i>	19	30		Low	Remove

- 6.4 The site is not influenced by any specific vegetation controls under the Shire of Moira planning scheme. This is based on a planning property report for each property being obtained from www.planning.vic.gov.au/ on 11/08/23.

- 6.5 Trees that are native to Victoria may be influenced by Clause 52.17 (Native vegetation) of the planning scheme because each parcel of land is larger than 0.4ha. This clause has specific obligations and requirements relating to indigenous trees, but there are also exemptions that apply under this clause. In particular, planted native vegetation is exempt from any requirements under this clause. The clause states at 52.17-7, Table of Exemptions;

Planted vegetation, Native vegetation that is to be removed, destroyed or lopped that was either planted or grown as a result of direct seeding.

This exemption does not apply to native vegetation planted or managed with public funding for the purpose of land protection or enhancing biodiversity unless the removal, destruction or lopping of the native vegetation is in accordance with written permission of the agency (or its successor) that provided the funding.

- 6.6 Native vegetation is defined as 'Plants that are indigenous to Victoria, including trees, shrubs, herbs, and grasses' under the Definitions of the State Planning provisions – Clause 73.
- 6.7 Each parcel of land is located in a Designated Bushfire Prone Area and exemptions are provided under Clause 52.12 of the Victoria Planning Provisions (Bushfire Protection:

Exemptions) in relation to any applicable vegetation controls. Trees that are situated within 10m of an existing dwelling used for accommodation (constructed before 10/09/2009) and within 4m of a property boundary fence are exempt from any permit requirements relating to vegetation removal (under certain conditions).

- 6.8 The site is located in the Murray fans Bioregion and Naturekit (DEECA) identifies the main Ecological Vegetation Class (EVC) for the site as Plains Woodland (EVC 803) with character tree species including *Eucalyptus largiflorens*, *Allocasuarina luehmannii*, *Eucalyptus microcarpa*, & *Eucalyptus porosa*.
- 6.9 There were tree species recorded in the study area, which are character species of Plains Woodland (EVC 803). Most of the character tree species examined were specimens of *Eucalyptus microcarpa* (Grey Box) but there was also a large number of *Eucalyptus camaldulensis* (River Red Gum), which is also a locally indigenous species.
- 6.10 The following table lists the 12 most frequently observed tree species (of 72 species) recorded on the site. This group of species below represents 71% of the 555 examined trees.

Species	No of trees	Tree type
<i>Eucalyptus camaldulensis</i>	150	Indigenous
<i>Corymbia citriodora</i>	48	Australian native
<i>Eucalyptus microcarpa</i>	39	Indigenous
<i>Eucalyptus sideroxylon</i>	39	Victorian native
<i>Eucalyptus leucoxylon</i>	22	Victorian native
<i>Melaleuca styphelioides</i>	18	Australian native
<i>Eucalyptus spathulata</i>	17	Australian native
<i>Corymbia maculata</i>	16	Victorian native
<i>Callistemon sp.</i>	14	Australian native
<i>Pyrus calleryana</i>	12	Exotic deciduous
<i>Grevillea robusta</i>	10	Australian native
<i>Fraxinus angustifolia</i> subsp. <i>angustifolia</i>	10	Exotic deciduous

- 6.11 Since there are obligations to retain indigenous trees on the site under the state planning scheme, a further means of identifying more valuable trees is the assigned 'Retention value'. The following table summarises the assigned values for the 555 trees examined on the site.

Retention value	No. of trees
None	109
Low	389
Moderate	53
High	4

- 6.11.1 The majority of trees listed above with High & Moderate retention values are locally indigenous tree species.

- 6.12 There were 193 trees recorded as indigenous.
- 6.13 A permit would be required under Clause 52.17 (Native vegetation) to remove, lop or destroy all of the trees identified as indigenous (Tree type – Appendix 1), aside from those influenced by Clause 52.12 (Bushfire Protection: Exemptions).

7 Discussion

The Australian Standard (AS4970-2009) – ‘Protection of trees on development sites’ puts forward a process for undertaking tree inspections and reports on property where development is being considered. It recommends a preliminary assessment be undertaken to help guide planners and property owners with regard to the preservation of existing trees; that is trees that might contribute to the completed proposal. The standard points out that the preliminary report ‘information is to be used by planners, architects and designers, in conjunction with any planning controls and other legislation, to develop the design layout in such a way that trees selected for retention are provided with enough space’.

These assessments typically reveal a range of trees with varying attributes for health, structure and overall value. Some trees may be considered insignificant for their size, age, species type or condition, but they might still be considered for retention because they are situated conveniently on the site. Conversely, some trees may be exceptional for various reasons but there may be no scope for their retention because of their location or other site constraints. An objective of the tree assessment is to determine the trees that may be preferable, in terms of preservation, and to identify poor or insignificant trees that might be easily replaced or replaced with better species.

The arborist must also exercise judgement and expertise with respect to the types of trees that are deemed suitable for retention, and they should also consider what stage the tree is at in its overall lifecycle.

There are 114 trees on the site or adjoining land within the number range 263-376 located in the northeastern corner of the site that appear not be influenced by any proposed site changes. This area of the site retains a relatively high degree of naturalness, particularly nearer to the river.

The arboricultural retention value of the examined vegetation across the site was variable.

The following 4 trees were assigned a retention value of ‘High’ and a recommendation of ‘Could be retained’. These trees were large indigenous trees that were reasonably free of any major defects or deficiencies. All of the trees in this group were located in the northeastern section of the site mentioned above.

- Tree 282, 292, 308, 315

The following 53 trees were assigned a retention value of ‘Moderate’ and a recommendation of ‘Could be retained’. These trees were mostly indigenous trees that were reasonably free of any major deficiencies.

- Tree 104, 106, 107, 108, 109, 112, 116, 117, 121, 122, 144, 237, 244, 245, 277, 283, 284, 300, 306, 307, 309, 310, 311, 312, 314, 379, 443, 444, 449, 452, 489, 501, 508, 509, 510, 514, 515, 519, 520, 537, 554, 555, 559, 568, 570, 572, 585, 601, 610, 611, 613, 622, 632

The following 181 trees were assigned a retention value of ‘Low’ and a recommendation of ‘Could be retained’. These trees were trees that exhibited deficiencies in health or structure, or they were smaller insignificant trees.

- Tree 31, 32, 33, 34, 35, 36, 37, 39, 40, 41, 42, 43, 44, 45, 46, 47, 48, 49, 50, 51, 52, 56, 58, 59, 60, 61, 62, 63, 64, 65, 66, 67, 68, 69, 71, 72, 73, 74, 76, 77, 78, 79, 80, 81, 96, 102, 110, 111, 115, 125, 139, 146, 147, 148, 189, 198, 208, 209, 225, 227, 238,

261, 280281, 286, 289, 290, 291, 293, 294, 301, 302, 313, 316, 317, 318, 319, 320, 321, 322, 323, 324, 325, 326, 327, 328, 329, 330, 331, 332, 334, 335, 336, 337, 338, 339, 340, 341, 342, 343, 344, 345, 346, 347, 348, 349, 350, 351, 352, 353, 354, 355, 356, 357, 358, 359, 360, 361, 362, 363, 364, 366, 367, 368, 369, 380, 441, 442, 445, 446, 448, 451, 458, 460, 461, 462, 463, 464, 465, 466, 467, 468, 469, 470, 471, 472, 473, 474, 475, 476, 477, 478, 479, 480, 494, 499, 512, 513, 521, 522, 529, 531, 533, 543, 544, 547, 556, 560, 561, 565, 566, 573, 599, 602, 607, 608, 618, 621, 624, 627,

The following 208 trees were assigned a retention value of 'Low' and a recommendation of 'Remove'. These trees were trees that exhibited deficiencies in health or structure, and they were often smaller insignificant trees.

- 38, 53, 54, 57, 70, 75, 83, 87, 89, 90, 91, 92, 93, 94, 97, 98, 99, 100, 101, 103, 113, 114, 120, 123, 124, 126, 128, 129, 130, 131, 132, 133, 134, 135, 136, 137, 138, 140, 141, 143, 145, 150, 152, 153, 155, 156, 157, 158, 159, 160, 161, 162, 167, 178, 179, 180, 181, 182, 183, 184, 185, 186, 187188, 190, 192, 193, 194, 196, 205, 206, 207, 212, 213, 216, 219, 226, 229, 230, 232, 233, 239, 240, 241, 242, 246, 247, 248, 249, 250, 251, 252, 253, 254, 255, 256, 257, 258, 259, 260, 262, 333, 365, 377, 378, 381, 412, 413, 414, 415, 416, 417, 418, 419, 420, 421, 422, 423, 424, 425, 426, 427, 428, 429, 430, 431, 433, 435, 436, 437, 438, 439, 440, 447, 450, 457, 486, 492, 493, 498, 500, 502, 503, 504, 505, 506, 507, 511, 518, 523, 524, 525, 526, 527, 532, 534, 535, 538, 539, 540, 541, 542, 546, 548, 551, 557, 558, 562, 563, 564, 569, 571, 575, 577, 578, 579, 580, 583, 584, 588, 592, 593, 594, 595, 596, 597, 598, 600, 604, 605, 606, 609, 615, 616, 619, 620, 628, 630, 633, 634, 635, 641, 642, 644, 645, 646, 647, 648,

The following 109 trees were assigned a retention value of 'None' and a recommendation of 'Remove'. These trees were trees that were defective or dead, or they are recognised as environmental weeds.

- 55, 82, 86, 88, 95, 105, 118, 119, 127, 142, 149, 151, 154, 163, 164, 165, 166, 168, 169, 170, 171, 172, 173, 174, 175, 176, 177, 191, 195, 197, 199, 200, 201, 202, 203, 204, 210, 211, 214, 215, 217, 218, 220, 221, 222, 223, 224, 228, 231, 234, 235, 236, 243, 278, 279, 303, 382, 432, 434, 459, 481, 482, 483484, 485, 487, 488, 490, 491, 495, 496, 497, 516, 517, 528, 530, 536, 545, 549, 550, 552, 553, 567, 574, 576, 581, 582, 586, 587, 589, 590, 591, 603, 612, 614, 617, 623, 625, 626, 629, 631, 636, 637, 638, 639, 640, 643, 650, 651,

The only means of determining the impact towards trees from any proposed site changes is to overlay the Tree Protection Zone and Structural Root Zone of trees identified to be retained and analyse the level of interference to the Tree Protection Zone from the proposed site changes.

A further factor that may influence development on the subject site will be the proposed design in the vicinity of the 65 neighbouring trees and the 31 street trees (Trees 1-30 & 411). The Tree Protection Zones for the street trees and neighbouring trees are illustrated on the plan at Appendix 3.

7.1 Tree protection zones on construction sites

The level of encroachment and the impact to specific trees can be estimated by comparing standard or modified tree protection clearances with those clearances provided to trees in the development design. The overall impact on any given tree will be based on the severity of encroachment into the respective tree protection zones. The degree of root activity in the tree protection zone can vary significantly, which can result in more or less severe impacts to trees. The most accurate means (although often impractical) of determining root activity in these zones is to undertake subsurface root investigations, but this is often impractical. The alternative to undertaking root investigations is to assign appropriate tree protection zones.

This report adopts AS4970-2009, Australian Standard – Protection of trees on development sites as the preferred tree protection method. The method provides a tree protection zone and a tree protection fencing distance (radial measurement from trunk centre) by using the width of the trunk at 1.4m above ground multiplied by 12. The prescribed TPZ distances are provided for each tree in Appendix 1 and illustrated for neighbouring, street trees and trees on site assigned a recommendation of 'Could be retained' at Appendix 3.

There is scope to reduce the tree protection zone by an area of 10% without further investigations. The rationale for any reduced tree protection distance is detailed in AS4970-2009 (*Australian Standard – Protection of trees on development sites*). Under encroachment Type A, it is acceptable to reduce the Tree Protection Zone (TPZ) area by 10%. This translates to a reduction in radial clearance distance of approximately 33% on one side of the tree only. This can be applied if there is contiguous space around the tree for root development to occur. The following diagram, from AS4970-2009, is provided to illustrate the approach.

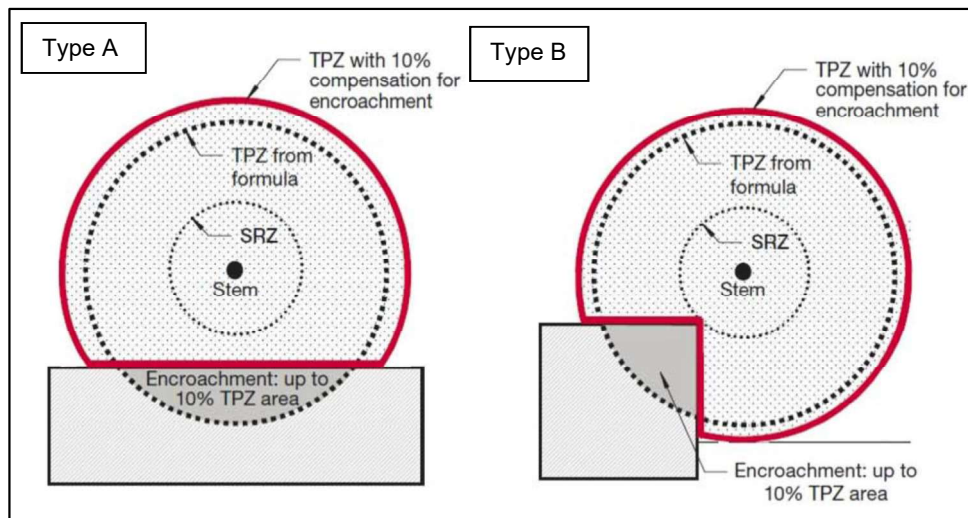

8 Recommendations

- 8.1 The arboricultural retention value of the examined vegetation on the site was variable.
- 8.2 There are 114 trees on the site or adjoining land within the number range 263-376 located in the northeastern corner of the site that appear not be influenced by any proposed site changes. This area of the site retains a relatively high degree of naturalness, particularly nearer to the river.
- 8.3 Four (4) trees were assigned a retention value of 'High' and a recommendation of 'Could be retained'. These trees were large indigenous trees that were reasonably free of any major defects or deficiencies. All of the trees in this group were located in the northeastern section of the site where no site changes are proposed.

- 8.4 Fifty- three (53) trees were assigned a retention value of 'Moderate' and a recommendation of 'Could be retained'. These trees were mostly indigenous trees that were reasonably free of any major deficiencies.
- 8.5 One hundred and eighty-one (181) trees were assigned a retention value of 'Low' and a recommendation of 'Could be retained'. These trees were trees that exhibited deficiencies in health or structure, or they were smaller insignificant trees.
- 8.6 Two hundred and eight (208) trees were assigned a retention value of 'Low' and a recommendation of 'Remove'. These trees were trees that exhibited deficiencies in health or structure, and they were often smaller insignificant trees.
- 8.7 One hundred and nine (109) trees were assigned a retention value of 'None' and a recommendation of 'Remove'. These trees were trees that were defective or dead, or they are recognised as environmental weeds.
- 8.8 Amongst the 193 trees identified as indigenous, there were 23 indigenous trees recommended for removal because of poor health or structure.
- 8.9 The design response will need to consider the 65 neighbouring trees and the 31 street trees (Trees 1-30 & 411). The Tree Protection Zones for the street trees and neighbouring trees are illustrated on the plan at Appendix 3.
- 8.10 Neighbouring tree groups 1, 2, 7, 8 & 12 would also need to be considered in the design response.
- 8.11 The proposed removals of any indigenous trees would need to be examined by a suitably qualified ecologist to determine the obligations and requirements under Clause 52.17 (Native Vegetation). A large number of tree removals may trigger a referral to the Department of Energy, Environment and Climate Action.



Dean Simonsen (BAppSc *Melb.*)
Consultant Arborist

9 References

Australian Standard AS 4970, 2009. *Protection of trees on development sites*. Standards Australia

White, M., Cheal, D., Carr, G. W., Adair, R., Blood, K. and Meagher, D. (2018). *Advisory list of environmental weeds in Victoria*. Arthur Rylah Institute for Environmental Research Technical Report Series No. 287. Department of Environment, Land, Water and Planning, Heidelberg, Victoria

10 Definitions

The TPZ and SRZ are defined in AS4970-2009, Australian Standard – Protection of trees on development sites as:

Tree protection zone (TPZ)

A specified area above and below ground and at a given distance from the trunk set aside for the protection of a tree's roots and crown to provide for the viability and stability of a tree to be retained where it is potentially subject to damage by development.

Structural root zone (SRZ)

The area around the base of a tree required for the tree's stability in the ground. The woody root growth and soil cohesion in this area are necessary to hold the tree upright. The SRZ is nominally circular with the trunk at its centre and is expressed by its radius in metres. This zone considers a tree's structural stability only, not the root zone required for a tree's vigour and long-term viability, which will usually be a much larger area.

11 Expertise of Arborist to prepare report**Qualifications and expertise of consultant**

- Bachelor of Applied Science, Horticulture (Plant Production) – University of Melbourne, Burnley College.
- Diploma of Applied Science, Horticulture (Arboriculture) – University of Melbourne, Burnley College. Dux of Arboriculture.
- More than 25 years of experience in the arboriculture/horticulture industry (private and local government experience).
- Consultant Arborist and Director at Tree Logic Pty Ltd from June 1999 to September 2011.
- Manager of Arboriculture – Royal Botanic Gardens, Melbourne (27 Months 1997-1999).
- Secretary for the Victorian Tree Industry Organisation (VTIO) 2007-2012.
- Financial member of the International Society of Arboriculture (ISA).
- Trained and registered to use VALID Tree Risk Assessment method.
- Presented paper at the International Society of Arboriculture Conference, 2011 at Parramatta, NSW.

Expertise to prepare report

- My qualifications and experience have primarily involved the management of tree issues in the urban landscape. Specifically, this has involved hazard, general or detailed assessment of tree condition on private and public land with recommendations made on preservation strategies or remedial works.
- Tree assessments to establish tree health, tree structure and arboricultural values are core components of Treemap Arboriculture's business activities.
- Prepared in excess of 4000 development reports and 500 Tree Management Plans.
- I have experience at Victorian Civil Administrative Tribunal and the magistrate's court as an expert witness on arboricultural matters.
- I have inspected and assessed well over one hundred thousand trees and managed assessment programs for at least ten times as many.

No	SPECIES	COMMON NAME	DBH (cm)	TPZ AS4970	SRZ AS4970	HxW (m)	AGE	HEALTH	STRUCTURE	FORM	ULE	COMMENT	TREE TYPE	RETENTION VALUE	RECOMMEND	X coordinate MGA Zone 55	Y coordinate MGA Zone 55
472	<i>Eucalyptus camaldulensis</i>	River Red Gum	5	2.00	1.50	6x4	Semi-mature	Fair	Fair	Asymmetric	50+ years		Indigenous	Low	Could be retained	407486.529	6013267.093
473	<i>Eucalyptus camaldulensis</i>	River Red Gum	11.6 (12.5)	2.00	1.50	7x4	Semi-mature	Fair	Poor	Minor asymmetry	15 to 30 years		Indigenous	Low	Could be retained	407484.754	6013266.961
474	<i>Eucalyptus camaldulensis</i>	River Red Gum	4	2.00	1.50	3x1	Semi-mature	Fair	Fair	Minor asymmetry	15 to 30 years		Indigenous	Low	Could be retained	407485.201	6013266.991
475	<i>Eucalyptus camaldulensis</i>	River Red Gum	6.6 (6.5)	2.00	1.50	5x3	Semi-mature	Fair	Poor	Minor asymmetry	30 to 50 years		Indigenous	Low	Could be retained	407481.093	6013266.603
476	<i>Eucalyptus camaldulensis</i>	River Red Gum	8	2.00	1.50	5x3	Semi-mature	Fair	Fair	Asymmetric	30 to 50 years		Indigenous	Low	Could be retained	407475.915	6013266.941
477	<i>Eucalyptus camaldulensis</i>	River Red Gum	9	2.00	1.50	6x3	Semi-mature	Fair	Fair	Asymmetric	30 to 50 years		Indigenous	Low	Could be retained	407475.973	6013267.098
478	<i>Eucalyptus camaldulensis</i>	River Red Gum	18.10 (18.9)	2.00	1.50	9x4	Semi-mature	Fair	Fair	Symmetric	30 to 50 years		Indigenous	Low	Could be retained	407467.758	6013267.336
479	<i>Eucalyptus microcarpa</i>	Grey Box	15.15 (15.59)	2.00	1.50	9x4	Semi-mature	Fair	Fair	Symmetric	15 to 30 years	Base sprouts, bifurcation with included bark	Indigenous	Low	Could be retained	407467.949	6013267.921
480	<i>Eucalyptus microcarpa</i>	Grey Box	53.15 (53.15)	7.08	2.75	17x12	Semi-mature	Fair	Poor	Symmetric	15 to 30 years		Indigenous	Low	Could be retained	407467.949	6013267.921
481	<i>Corymbia citriodora</i>	Lemon-scented Gum	28.27 (38.9)	4.67	2.31	14x14	Semi-mature	Fair	Poor	Minor asymmetry	0 years	Bifurcation of main stem, Woody weed	Australian native	None	Remove	407478.724	6013205.020
482	<i>Corymbia citriodora</i>	Lemon-scented Gum	23.12 (25.9)	3.11	1.95	13x11	Semi-mature	Fair	Fair to Poor	Minor asymmetry	0 years	Acute branch attachments, Woody weed	Australian native	None	Remove	407485.082	6013205.506
483	<i>Corymbia citriodora</i>	Lemon-scented Gum	30	3.60	2.07	11x10	Semi-mature	Fair	Fair	Minor asymmetry	0 years	Woody weed	Australian native	None	Remove	407479.081	6013194.915
484	<i>Corymbia citriodora</i>	Lemon-scented Gum	20.18 (26.9)	3.23	1.98	13x8	Semi-mature	Fair	Poor	Minor asymmetry	0 years	Previously lopped, Woody weed	Australian native	None	Remove	407485.188	6013195.178
485	<i>Corymbia citriodora</i>	Lemon-scented Gum	26	3.12	1.95	15x12	Semi-mature	Fair	Poor	Minor asymmetry	0 years	Bifurcation of main stem, Woody weed	Australian native	None	Remove	407491.337	6013194.815
486	<i>Eucalyptus camaldulensis</i>	River Red Gum	26	3.12	1.95	12x5	Semi-mature	Fair	Poor	Minor asymmetry	5 to 15 years	Previously lopped	Indigenous	Low	Remove	407494.438	6013194.688
487	<i>Corymbia citriodora</i>	Lemon-scented Gum	26	3.12	1.95	12x3	Semi-mature	Fair	Fair	Minor asymmetry	0 years	Woody weed	Australian native	None	Remove	407497.047	6013194.716
488	<i>Corymbia citriodora</i>	Lemon-scented Gum	26	3.12	1.95	14x8	Semi-mature	Fair	Poor	Minor asymmetry	0 years	Woody weed	Australian native	None	Remove	407498.426	6013191.311
489	<i>Eucalyptus camaldulensis</i>	River Red Gum	43	5.16	2.41	17x11	Semi-mature	Fair to Poor	Fair	Minor asymmetry	30 to 50 years		Indigenous	Moderate	Could be retained	407498.260	6013188.338
490	<i>Corymbia citriodora</i>	Lemon-scented Gum	25	3.00	1.92	13x9	Semi-mature	Fair	Poor	Asymmetric	0 years	Woody weed	Australian native	None	Remove	407498.927	6013185.049
491	<i>Corymbia citriodora</i>	Lemon-scented Gum	25	3.00	1.92	13x9	Semi-mature	Fair	Poor	Asymmetric	0 years	Woody weed	Australian native	None	Remove	407498.927	6013185.049
492	<i>Eucalyptus camaldulensis</i>	River Red Gum	43	5.16	2.41	12x13	Semi-mature	Fair	Fair	Minor asymmetry	15 to 30 years	Woody weed	Indigenous	Low	Remove	407485.694	6013188.148
493	<i>Eucalyptus nicholii</i>	Narrow-leaved Paperbark	23	2.76	1.85	9x6	Semi-mature	Fair	Poor	Minor asymmetry	5 to 15 years	Bifurcation of main stem with included bark	Australian native	Low	Remove	407483.314	6013183.158
494	<i>Eucalyptus microcarpa</i>	Grey Box	24.23 (33.2)	3.98	2.16	13x9	Semi-mature	Fair	Fair to Poor	Symmetric	15 to 30 years	Bifurcation of main stem	Indigenous	Low	Could be retained	407477.425	6013181.626
495	<i>Corymbia citriodora</i>	Lemon-scented Gum	39	4.68	2.31	13x12	Semi-mature	Fair	Poor	Minor asymmetry	0 years	Multiple bifurcations with included bark, Woody weed	Australian native	None	Remove	407485.835	6013177.727
496	<i>Corymbia citriodora</i>	Lemon-scented Gum	39	4.68	2.31	15x12	Semi-mature	Fair	Fair to Poor	Minor asymmetry	0 years	Woody weed	Australian native	None	Remove	407491.599	6013176.993
497	<i>Corymbia citriodora</i>	Lemon-scented Gum	27	3.24	1.98	13x12	Semi-mature	Fair	Fair to Poor	Asymmetric	0 years	Woody weed	Australian native	None	Remove	407485.480	6013172.362
498	<i>Eucalyptus baxteri</i>	Brown Stringybark	8.8.7 (13.3)	2.00	1.50	6x4	Semi-mature	Very Poor	Fair to Poor	Asymmetric	1 to 5 years		Australian native	Low	Remove	407489.579	6013172.228
499	<i>Eucalyptus buxifolia</i>	Yellow Gum	34	4.08	2.18	12x12	Semi-mature	Fair to Poor	Fair	Minor asymmetry	15 to 30 years		Victorian native	Low	Could be retained	407496.704	6013179.575
500	<i>Eucalyptus camaldulensis</i>	River Red Gum	13	2.00	1.50	5x2	Semi-mature	Very Poor	Fair to Poor	Asymmetric	1 to 5 years		Indigenous	Low	Remove	407485.453	6013210.885
501	<i>Eucalyptus microcarpa</i>	River Red Gum	58	6.98	2.74	12x13	Semi-mature	Fair	Fair	Minor asymmetry	30 to 50 years	Slump re-sprout, bifurcation at base with included bark	Indigenous	Moderate	Could be retained	407488.717	6013215.514
502	<i>Eucalyptus microcarpa</i>	Grey Box	24.23 (33.2)	3.98	2.16	13x9	Semi-mature	Fair	Very poor	Symmetric	1 to 5 years		Indigenous	Low	Remove	407485.489	6013220.550
503	<i>Callistemon sp.</i>	Bottlebrush	10	2.00	1.50	2x2	Semi-mature	Fair	Poor	Symmetric	5 to 15 years		Australian native	Low	Remove	407478.644	6013215.925
504	<i>Callistemon sp.</i>	Bottlebrush	10	2.00	1.50	2x2	Semi-mature	Fair	Poor	Symmetric	5 to 15 years		Australian native	Low	Remove	407478.644	6013215.925
505	<i>Callistemon sp.</i>	Bottlebrush	10	2.00	1.50	2x3	Semi-mature	Fair	Poor	Symmetric	5 to 15 years		Australian native	Low	Remove	407478.625	6013220.550
506	<i>Callistemon sp.</i>	Bottlebrush	10	2.00	1.50	2x2	Semi-mature	Fair	Poor	Symmetric	5 to 15 years		Australian native	Low	Remove	407478.176	6013229.419
507	<i>Eucalyptus buxifolia</i>	Yellow Gum	35.28 (44.8)	5.38	2.45	12x13	Semi-mature	Fair	Poor	Minor asymmetry	5 to 15 years	Previously lopped, bifurcation of main stem with included bark	Victorian native	Low	Remove	407488.535	6013238.396
508	<i>Eucalyptus camaldulensis</i>	River Red Gum	49	5.88	2.55	14x14	Semi-mature	Fair	Fair	Minor asymmetry	30 to 50 years		Indigenous	Moderate	Could be retained	407485.425	6013248.227
509	<i>Eucalyptus camaldulensis</i>	River Red Gum	46	5.52	2.48	13x13	Semi-mature	Fair	Fair	Minor asymmetry	30 to 50 years		Indigenous	Moderate	Could be retained	407488.677	6013248.263
510	<i>Eucalyptus camaldulensis</i>	River Red Gum	42	5.04	2.39	12x13	Semi-mature	Fair	Fair	Minor asymmetry	30 to 50 years		Indigenous	Moderate	Could be retained	407485.680	6013252.664
511	<i>Melaleuca stypheloides</i>	Prickly-leaved Paperbark	15	2.00	1.55	4x3	Semi-mature	Fair	Poor	Minor asymmetry	5 to 15 years		Australian native	Low	Remove	407485.988	6013258.038
512	<i>Eucalyptus camaldulensis</i>	River Red Gum	10	2.00	1.50	5x3	Semi-mature	Fair	Fair	Minor asymmetry	30 to 50 years		Indigenous	Low	Could be retained	407501.733	6013250.796
513	<i>Eucalyptus camaldulensis</i>	River Red Gum	5	2.00	1.50	3x2	Semi-mature	Fair	Fair	Minor asymmetry	30 to 50 years		Indigenous	Low	Could be retained	407500.931	6013250.418
514	<i>Eucalyptus camaldulensis</i>	River Red Gum	41	4.92	2.36	12x12	Semi-mature	Fair	Fair	Minor asymmetry	30 to 50 years		Indigenous	Moderate	Could be retained	407486.175	6013264.278
515	<i>Eucalyptus camaldulensis</i>	River Red Gum	55	6.60	2.67	12x12	Semi-mature	Fair	Fair	Minor asymmetry	30 to 50 years		Indigenous	Moderate	Could be retained	407498.014	6013261.986
516	<i>Melaleuca artemisia</i>	Bracelet Honey-myrtle	20	2.40	1.75	3x4	Semi-mature	Fair	Fair to Poor	Asymmetric	0 years	Woody weed	Victorian native	None	Remove	407505.996	6013265.467
517	<i>Melaleuca artemisia</i>	Bracelet Honey-myrtle	20	2.40	1.75	3x4	Semi-mature	Fair	Fair to Poor	Asymmetric	0 years	Woody weed	Victorian native	None	Remove	407505.996	6013265.467
518	<i>Melaleuca artemisia</i>	Bracelet Honey-myrtle	20	2.40	1.75	3x4	Semi-mature	Fair	Fair to Poor	Asymmetric	0 years	Woody weed	Victorian native	None	Remove	407505.996	6013265.467
519	<i>Melaleuca artemisia</i>	Bracelet Honey-myrtle	33	2.00	1.55	2x4	Semi-mature	Fair	Fair	Minor asymmetry	5 to 15 years		Australian native	None	Remove	407519.223	6013263.980
520	<i>Eucalyptus camaldulensis</i>	River Red Gum	33	3.96	2.16	8x12	Semi-mature	Fair	Fair	Minor asymmetry	30 to 50 years		Indigenous	Moderate	Could be retained	407519.491	6013262.098
521	<i>Eucalyptus camaldulensis</i>	River Red Gum	30.27 (40.4)	4.85	2.35	8x12	Semi-mature	Fair	Fair to Poor	Minor asymmetry	30 to 50 years		Indigenous	Moderate	Could be retained	407529.668	6013262.664
522	<i>Eucalyptus microcarpa</i>	Grey Box	11	2.00	1.50	6x4	Semi-mature	Fair	Fair	Symmetric	50+ years		Indigenous	Low	Could be retained	407530.725	6013258.688
523	<i>Callistemon sp.</i>	Bottlebrush	10	2.00	1.50	2x2	Semi-mature	Fair	Fair to Poor	Asymmetric	15 to 30 years	Broken hanging branches, Multiple major limb failures, crown maintenance reqd	Indigenous	Low	Could be retained	407533.904	6013247.393
524	<i>Callistemon sp.</i>	Bottlebrush	10	2.00	1.50	2x2	Semi-mature	Fair	Poor	Symmetric	5 to 15 years		Australian native	Low	Remove	407540.928	6013265.420
525	<i>Callistemon sp.</i>	Bottlebrush	10	2.00	1.50	2x2	Semi-mature	Fair	Poor	Symmetric	5 to 15 years		Australian native	Low	Remove	407544.587	6013260.712
526	<i>Melaleuca uncinata</i>	Broombush	10	2.00	1.50	2x2	Semi-mature	Fair	Poor	Symmetric	5 to 15 years		Australian native	Low	Remove	407546.986	6013265.528
527	<i>Melaleuca decussata</i>	Tolem Poles	10	2.00	1.50	2x4	Semi-mature	Fair	Poor	Symmetric	5 to 15 years		Australian native	Low	Remove	407550.213	6013262.705
528	<i>Melaleuca artemisia</i>	Bracelet Honey-myrtle	20	2.40	1.75	3x6	Semi-mature	Fair	Poor	Asymmetric	5 to 15 years		Australian native	Low	Remove	407558.448	6013260.411
529	<i>Eucalyptus camaldulensis</i>	River Red Gum	45	5.40	2.46	9x12	Semi-mature	Fair to Poor	Fair	Minor asymmetry	15 to 30 years	Woody weed	Indigenous	None	Could be retained	407568.981	6013266.187
530	<i>Melaleuca artemisia</i>	Bracelet Honey-myrtle	20	2.40	1.75	3x6	Semi-mature	Fair	Fair	Asymmetric	5 to 15 years		Victorian native	None	Remove	407568.981	6013266.187
531	<i>Melaleuca artemisia</i>	Bracelet Honey-myrtle	20	2.40	1.75	3x6	Semi-mature	Fair	Fair	Asymmetric	5 to 15 years		Victorian native	None	Remove	407568.981	6013266.187
532	<i>Melaleuca artemisia</i>	Bracelet Honey-myrtle	30	3.60	2.07	8x6	Semi-mature	Fair to Poor	Fair to Poor	Minor asymmetry	30 to 50 years	Fungal bracket on lower trunk	Australian native	None	Could be retained	407568.981	6013266.187
533	<i>Eucalyptus camaldulensis</i>	Swamp Mahoe	33.23 (40.2)	4.82	2.34	9x10	Semi-mature	Fair	Fair to Poor	Minor asymmetry	15 to 30 years		Australian native	Low	Could be retained	407568.775	6013265.036
534	<i>Allocasuarina littoralis</i>	Black She-oak	24	2.88	1.89	7x7	Semi-mature	Fair to Poor	Fair	Minor asymmetry	15 to 30 years		Victorian native	Low	Remove	407574.132	6013263.533
535	<i>Eucalyptus buxifolia</i>	Yellow Gum	7	2.00	1.50	2x3	Semi-mature										

No	SPECIES	COMMON NAME	DBH (cm)	TPZ (m)	SRZ AS4970 (m)	HxW (m)	AGE	HEALTH	STRUCTURE	FORM	ULE	COMMENT	TREE TYPE	RETENTION VALUE	RECOMMEND	X coordinate MGA Zone 55	Y coordinate MGA Zone 55
548	<i>Melaleuca styphelioides</i>	Prickly-leaved Paperbark	40	4.80	2.34	4x6	Semi-mature	Fair	Poor	Minor asymmetry	15 to 30 years		Australian native	Low	Remove	407607.200	6013211.831
549	<i>Corymbia citriodora</i>	Lemon-scented Gum	33	3.96	2.16	16x14	Semi-mature	Fair	Fair to Poor	Minor asymmetry	0 years	Acute branch attachments, Woody weed	Australian native	None	Remove	407605.021	6013206.210
550	<i>Corymbia citriodora</i>	Lemon-scented Gum	29	3.48	2.04	14x12	Semi-mature	Fair	Poor	Minor asymmetry	0 years	Bifurcation of main stem with included bark, Woody weed	Australian native	None	Remove	407597.480	6013202.066
551	<i>Eucalyptus microcarpa</i>	Grey Box	15, 15 (21.2)	2.54	1.79	7x6	Semi-mature	Fair	Poor	Minor asymmetry	5 to 15 years	Bifurcation of main stem with included bark, Woody weed	Indigenous	Low	Remove	407594.248	6013190.516
552	<i>Corymbia citriodora</i>	Lemon-scented Gum	31	3.72	2.10	16x13	Semi-mature	Fair	Fair	Minor asymmetry	0 years	Bifurcation of main stem with included bark, Woody weed	Australian native	None	Remove	407593.954	6013187.193
553	<i>Corymbia maculata</i>	Spotted Gum	20, 18 (26.9)	3.23	1.98	10x7	Semi-mature	Fair	Poor	Minor asymmetry	0 years	Bifurcation of main stem with included bark, Woody weed	Victorian native	None	Remove	407598.634	6013160.140
554	<i>Eucalyptus microcarpa</i>	Grey Box	49	5.88	2.95	15x13	Semi-mature	Fair	Fair	Minor asymmetry	30 to 50 years		Indigenous	Moderate	Could be retained	407608.086	6013160.178
555	<i>Eucalyptus microcarpa</i>	Grey Box	31	6.12	2.59	16x15	Semi-mature	Fair	Fair	Minor asymmetry	50+ years		Indigenous	Moderate	Could be retained	407605.216	6013173.983
556	<i>Eucalyptus sideroxylon</i>	Red Ironbark	33	3.96	2.16	14x11	Semi-mature	Fair	Fair	Minor asymmetry	30 to 50 years		Victorian native	Low	Could be retained	407599.834	6013167.873
557	<i>Melaleuca styphelioides</i>	Prickly-leaved Paperbark	25	3.00	1.92	3x6	Semi-mature	Fair	Poor	Minor asymmetry	15 to 30 years		Australian native	Low	Remove	407608.321	6013168.140
558	<i>Melaleuca styphelioides</i>	Prickly-leaved Paperbark	40	4.80	2.34	4x6	Semi-mature	Fair	Poor	Minor asymmetry	15 to 30 years		Australian native	Low	Remove	407605.617	6013161.229
559	<i>Eucalyptus camaldulensis</i>	River Red Gum	39	4.68	2.31	11x12	Semi-mature	Fair	Fair	Minor asymmetry	50+ years		Indigenous	Moderate	Could be retained	407608.163	6013155.824
560	<i>Eucalyptus eucalypton</i>	River Red Gum	6	2.00	1.50	3x2	Semi-mature	Fair	Fair	Minor asymmetry	50+ years		Indigenous	Low	Could be retained	407605.488	6013154.220
561	<i>Eucalyptus eucalypton</i>	Yellow Gum	16.9 (18.4)	2.21	1.69	5x6	Semi-mature	Fair	Fair to Poor	Minor asymmetry	15 to 30 years		Victorian native	Low	Could be retained	407601.687	6013148.411
562	<i>Melaleuca styphelioides</i>	Prickly-leaved Paperbark	40	4.80	2.34	5x6	Semi-mature	Fair	Poor	Minor asymmetry	5 to 15 years		Australian native	Low	Remove	407607.979	6013146.076
563	<i>Eucalyptus brandiana</i>	Square-fruit Mallet	20	2.40	1.75	4x7	Semi-mature	Fair	Poor	Minor asymmetry	5 to 15 years		Australian native	Low	Remove	407599.421	6013156.893
564	<i>Eucalyptus bruceata</i>	Yellow Gum	12, 12, 12, 10 (26)	3.12	1.95	6x7	Semi-mature	Fair	Poor	Minor asymmetry	5 to 15 years		Victorian native	Low	Remove	407599.660	6013162.877
565	<i>Eucalyptus eucalypton</i>	Yellow Gum	25, 21, 16 (36.4)	4.37	2.25	7x11	Semi-mature	Fair	Fair to Poor	Minor asymmetry	15 to 30 years		Victorian native	Low	Could be retained	407598.091	6013154.141
566	<i>Eucalyptus camaldulensis</i>	River Red Gum	11	2.00	1.50	5x4	Semi-mature	Fair	Fair	Minor asymmetry	50+ years		Indigenous	Low	Could be retained	407598.015	6013148.749
567	<i>Corymbia citriodora</i>	Lemon-scented Gum	21	1.82	1.78	12x9	Semi-mature	Fair	Fair to Poor	Minor asymmetry	0 years	Woody weed	Australian native	None	Remove	407598.560	6013140.559
568	<i>Eucalyptus microcarpa</i>	Grey Box	41	4.92	2.36	15x15	Semi-mature	Fair	Fair	Minor asymmetry	50+ years		Indigenous	Moderate	Could be retained	407591.600	6013142.936
569	<i>Melaleuca styphelioides</i>	Prickly-leaved Paperbark	15	2.00	1.55	3x4	Semi-mature	Poor	Poor	Minor asymmetry	5 to 15 years		Australian native	Low	Remove	407596.081	6013140.168
570	<i>Eucalyptus camaldulensis</i>	River Red Gum	36	4.32	2.24	10x11	Semi-mature	Fair	Fair	Minor asymmetry	50+ years		Indigenous	Moderate	Could be retained	407590.648	6013143.396
571	<i>Eucalyptus eucalypton</i>	Yellow Gum	14.7 (15.7)	2.00	1.58	5x6	Semi-mature	Poor	Poor	Minor asymmetry	5 to 15 years		Victorian native	Low	Remove	407570.583	6013143.295
572	<i>Eucalyptus camaldulensis</i>	River Red Gum	54, 34, 32 (71.4)	8.57	2.99	18x19	Semi-mature	Fair	Fair to Poor	Minor asymmetry	30 to 50 years	Surface roots	Indigenous	Moderate	Could be retained	407599.246	6013143.948
573	<i>Pinus pinaster</i>	Maritime Pine	32	3.84	2.13	8x8	Semi-mature	Fair	Fair	Symmetric	30 to 50 years		Exotic conifer	Low	Could be retained	407598.268	6013138.127
574	<i>Fraxinus angustifolia</i> subsp. <i>angustifolia</i>	Desert Ash	5	2.00	1.50	3x2	Semi-mature	Fair	Fair	Symmetric	0 years	Woody weed	Exotic deciduous	None	Remove	407569.932	6013165.993
575	<i>Melaleuca bruceata</i>	Yellow Gum	20	2.40	1.75	4x4	Semi-mature	Fair	Poor	Symmetric	5 to 15 years		Australian native	Low	Remove	407571.372	6013173.607
576	<i>Melaleuca bruceata</i>	Slip Oak	20	2.40	1.75	7x6	Semi-mature	Fair	Fair	Symmetric	5 to 15 years	Woody weed	Australian native	None	Remove	407571.884	6013176.550
577	<i>Washingtonia robusta</i>	Mexican Fan Palm	25	2.50	NA	3x3	Maturing	Fair	Fair	Symmetric	50+ years		Palm	Low	Remove	407570.078	6013178.962
578	<i>Melaleuca manifolia</i>	Snow in Summer	15	2.00	1.55	3x3	Semi-mature	Fair	Poor	Minor asymmetry	5 to 15 years		Australian native	Low	Remove	407572.706	6013160.825
579	<i>Melaleuca manifolia</i>	Snow in Summer	20	2.40	1.75	4x4	Semi-mature	Fair	Poor	Minor asymmetry	5 to 15 years		Australian native	Low	Remove	407573.660	6013165.252
580	<i>Melaleuca manifolia</i>	Snow in Summer	10	2.00	1.50	2x2	Semi-mature	Fair	Poor	Minor asymmetry	5 to 15 years		Australian native	Low	Remove	407574.257	6013169.274
581	<i>Corymbia citriodora</i>	Lemon-scented Gum	41	4.92	2.36	19x15	Semi-mature	Fair	Poor	Minor asymmetry	0 years	Bifurcation of main stem with included bark, Woody weed	Australian native	None	Remove	407559.844	6013204.438
582	<i>Corymbia citriodora</i>	Lemon-scented Gum	27	3.24	1.98	10x10	Semi-mature	Fair	Fair to Poor	Minor asymmetry	0 years		Australian native	None	Remove	407566.552	6013213.183
583	<i>Eucalyptus melioides</i>	Yellow Box	43, 37 (56.7)	6.80	2.71	16x13	Semi-mature	Fair	Very Poor	Minor asymmetry	5 to 15 years	Multiple bifurcations with included bark	Indigenous	Low	Remove	407566.797	6013229.865
584	<i>Eucalyptus melioides</i>	Yellow Box	40	6.80	2.34	14x14	Semi-mature	Fair	Poor	Asymmetric	30 to 50 years	Major limbfall evidence	Indigenous	Low	Remove	407565.118	6013231.234
585	<i>Eucalyptus sideroxylon</i>	Red Ironbark	47	5.64	2.50	17x17	Semi-mature	Fair	Fair	Minor asymmetry	30 to 50 years		Victorian native	Moderate	Could be retained	407543.208	6013227.191
586	<i>Corymbia maculata</i>	Spotted Gum	36	4.32	2.24	13x10	Semi-mature	Fair	Poor	Minor asymmetry	0 years	Multiple bifurcations with included bark, Woody weed	Victorian native	None	Remove	407545.661	6013223.532
587	<i>Corymbia citriodora</i>	Lemon-scented Gum	29	3.48	2.04	15x13	Semi-mature	Fair	Poor	Minor asymmetry	0 years	Crossing ribbing branches, Woody weed	Australian native	None	Remove	407546.892	6013213.564
588	<i>Callistemon salignus</i>	Willow Bottlebrush	24	2.88	1.89	7x6	Semi-mature	Fair	Poor	Minor asymmetry	5 to 15 years		Australian native	Low	Remove	407559.104	6013206.097
589	<i>Corymbia citriodora</i>	Lemon-scented Gum	22, 17 (27.8)	3.34	2.01	11x12	Semi-mature	Fair	Poor	Minor asymmetry	0 years	Bifurcation of main stem with included bark, Woody weed	Australian native	None	Remove	407542.138	6013216.197
590	<i>Corymbia citriodora</i>	Lemon-scented Gum	20	2.40	1.75	12x12	Semi-mature	Fair	Poor	Minor asymmetry	0 years		Australian native	None	Remove	407526.865	6013216.857
591	<i>Corymbia citriodora</i>	Lemon-scented Gum	17, 16 (23.3)	2.80	1.86	11x11	Semi-mature	Fair	Poor	Minor asymmetry	0 years		Australian native	None	Remove	407531.694	6013213.905
592	<i>Fraxinus 'Raywood'</i>	Claret Ash	34	4.08	2.18	9x10	Semi-mature	Fair	Fair to Poor	Minor asymmetry	15 to 30 years		Exotic deciduous	Low	Remove	407528.652	6013209.114
593	<i>Fraxinus 'Raywood'</i>	Claret Ash	33	3.96	2.16	9x9	Semi-mature	Fair	Fair to Poor	Minor asymmetry	15 to 30 years		Exotic deciduous	Low	Remove	407533.183	6013208.342
594	<i>Fraxinus 'Raywood'</i>	Claret Ash	43	5.16	2.41	7x10	Semi-mature	Fair	Fair to Poor	Minor asymmetry	15 to 30 years		Exotic deciduous	Low	Remove	407532.438	6013203.534
595	<i>Eucalyptus polyanthemos</i>	Red Box	54	6.48	2.65	18x17	Semi-mature	Fair	Very Poor	Asymmetric	1 to 5 years	Advanced epicormics, Previously lopped	Victorian native	Low	Remove	407513.835	6013219.751
596	<i>Melaleuca bracteata</i>	Black Tea-tree	18, 18, 15, 14 (36)	4.32	2.24	7x7	Maturing	Fair	Poor	Symmetric	1 to 5 years		Australian native	Low	Remove	407508.352	6013231.468
597	<i>Callistemon sp.</i>	Bottlebrush	15	2.00	1.55	3x3	Semi-mature	Poor	Poor	Minor asymmetry	5 to 15 years		Australian native	Low	Remove	407513.981	6013233.927
598	<i>Callistemon sp.</i>	Bottlebrush	15	2.00	1.55	3x4	Semi-mature	Poor	Poor	Minor asymmetry	5 to 15 years		Australian native	Low	Remove	407516.364	6013235.892
599	<i>Eucalyptus tereticornis</i>	Great Red Gum	22	3.04	2.09	12x12	Semi-mature	Fair	Fair to Poor	Minor asymmetry	15 to 30 years		Victorian native	Low	Could be retained	407513.934	6013233.822
600	<i>Eucalyptus melioides</i>	Snow in Summer	25	3.06	2.16	12x9	Semi-mature	Fair	Fair	Minor asymmetry	30 to 50 years		Australian native	Miscate	Could be retained	407516.804	6013242.160
601	<i>Eucalyptus microcarpa</i>	Grey Box	15, 10 (18)	2.16	1.67	8x4	Semi-mature	Fair	Poor	Minor asymmetry	15 to 30 years		Indigenous	None	Could be retained	407518.803	6013243.296
602	<i>Robinia pseudoacacia</i>	Locust	23	2.76	1.85	5x5	Semi-mature	Poor	Poor	Minor asymmetry	0 years	Woody weed	Exotic deciduous	None	Remove	407507.520	6013169.335
603	<i>Syzygium sp.</i>	Lilly Pilly	8	2.00	1.50	2x2	Semi-mature	Fair	Fair	Manipulated	5 to 15 years		Australian native	Low	Remove	407505.098	6013170.963
604	<i>Syzygium sp.</i>	Lilly Pilly	8	2.00	1.50	2x2	Semi-mature	Fair	Fair	Manipulated	5 to 15 years		Australian native	Low	Remove	407510.676	6013167.011
605	<i>Eucalyptus camaldulensis</i>	River Red Gum	39	4.68	2.31	9x9	Semi-mature	Poor	Fair	Asymmetric	5 to 15 years	In decline	Indigenous	Low	Remove	407485.942	6013165.097
606	<i>Eucalyptus camaldulensis</i>	River Red Gum	44	5.28	2.43	12x11	Semi-mature	Fair to Poor	Fair	Asymmetric	15 to 30 years	In decline	Indigenous	Low	Could be retained	407485.571	6013156.034
607	<i>Eucalyptus camaldulensis</i>	River Red Gum	35	4.20	2.21	8x7	Semi-mature	Fair to Poor	Fair	Asymmetric	15 to 30 years	In decline	Indigenous	Low	Could be retained	407486.229	6013146.857
608	<i>Eucalyptus camaldulensis</i>	Swamp Mallet	24, 22 (32.6)	3.91	2.15	9x12	Semi-mature	Fair to Poor	Fair to Poor	Asymmetric	15 to 30 years		Australian native	Low	Remove	407494.023	6013152.269
609	<i>Eucalyptus camaldulensis</i>	River Red Gum	55	6.60	2.67	17x15	Semi-mature	Fair	Fair to Poor	Asymmetric	30 to 50 years		Indigenous	Moderate	Could be retained	407494.754	6013147.899
610	<i>Eucalyptus microcarpa</i>	Grey Box	43	5.16	2.41	17x16	Semi-mature	Fair	Fair	Minor asymmetry	30 to 50 years		Indigenous	Moderate	Could be retained	407498.464	6013145.240
611	<i>Melaleuca artemisia</i>	Bracelet Honey-myrtle	20	2.40	1.75	2x5	Semi-m										

No	SPECIES	COMMON NAME	DBH (cm)	TPZ AS4970 (m)	SRZ AS4970 (m)	H&W (m)	AGE	HEALTH	STRUCTURE	FORM	ULE	COMMENT	TREE TYPE	RETENTION VALUE	RECOMMEND	X coordinate MGA Zone 55	Y coordinate MGA Zone 55
619	<i>Eucalyptus creomophila</i>	Horned Maille	10	2.00	1.50	7x4	Semi-mature	Fair	Fair to Poor	Asymmetric	5 to 15 years		Australian native	Low	Remove	407520.957	6013169.235
620	<i>Callistemon sp.</i>	Bottlebrush	10	2.00	1.50	2x4	Semi-mature	Fair	Very poor	Asymmetric	1 to 5 years	Collapsing	Australian native	Low	Remove	407526.287	6013169.424
621	<i>Hymenosporum flavum</i>	Native Frangipani	14	2.00	1.50	4x4	Semi-mature	Fair	Fair	Minor asymmetry	15 to 30 years		Australian native	Low	Could be retained	407526.825	6013165.144
622	<i>Eucalyptus polyanthemos</i>	Red Box	47	5.64	2.50	15x12	Semi-mature	Fair	Fair	Minor asymmetry	50+ years		Victorian native	Moderate	Could be retained	407527.192	6013153.018
623	<i>Corymbia maculata</i>	Spotted Gum	20, 18, 17, 11 (33.7)	4.04	2.18	12x11	Semi-mature	Fair	Poor	Minor asymmetry	0 years	Acute branch attachments, Woody weed	Victorian native	None	Remove	407544.349	6013150.032
624	<i>Eucalyptus nicholii</i>	Narrow-leaved Paperbark	34	4.08	2.18	12x8	Semi-mature	Fair to Poor	Fair	Minor asymmetry	15 to 30 years		Australian native	Low	Could be retained	407546.830	6013144.483
625	<i>Corymbia citriodora</i>	Lemon-scented Gum	38	4.56	2.29	17x10	Semi-mature	Fair	Poor	Minor asymmetry	0 years	Woody weed	Australian native	None	Remove	407526.806	6013154.531
626	<i>Corymbia citriodora</i>	Lemon-scented Gum	63	7.56	2.83	20x14	Semi-mature	Fair	Poor	Minor asymmetry	0 years	Bifurcation of main stem with included bark, Woody weed	Australian native	None	Remove	407520.082	6013156.192
627	<i>Morus sp.</i>	Mulberry	24	2.88	1.89	5x6	Semi-mature	Fair	Fair	Minor asymmetry	15 to 30 years		Exotic deciduous	Low	Could be retained	407526.866	6013160.208
628	<i>Cupressus sp.</i>	Cypress	15, 15, 15, 15 (30)	3.60	2.07	7x9	Semi-mature	Fair	Poor	Minor asymmetry	5 to 15 years		Exotic conifer	Low	Remove	407511.221	6013158.097
629	<i>Mealeuca armillaris</i>	Bracelet Honey-myrtle	50	6.00	2.57	5x10	Semi-mature	Fair	Failed	Major asymmetry	0 years	Woody weed	Victorian native	None	Remove	407504.180	6013156.575
630	<i>Callistemon citrinus</i>	Crimson Bottlebrush	15	2.00	1.55	2x3	Semi-mature	Fair	Poor	Major asymmetry	1 to 5 years		Victorian native	Low	Remove	407505.789	6013160.967
631	<i>Mealeuca armillaris</i>	Bracelet Honey-myrtle	10	2.00	1.50	5x5	Semi-mature	Fair	Poor	Asymmetric	0 years	Woody weed	Victorian native	None	Remove	407497.391	6013159.166
632	<i>Eucalyptus camaldulensis</i>	River Red Gum	39	4.68	2.31	15x14	Semi-mature	Fair	Fair	Minor asymmetry	30 to 50 years		Indigenous	Moderate	Could be retained	407494.487	6013163.293
633	<i>Cupressus sp.</i>	Cypress	10, 7, 7 (14.1)	2.00	1.51	6x6	Semi-mature	Fair	Poor	Asymmetric	5 to 15 years		Exotic conifer	Low	Remove	407496.645	6013164.564
634	<i>Cupressus sp.</i>	Cypress	15, 15 (21.2)	2.54	1.79	7x6	Semi-mature	Fair	Poor	Asymmetric	5 to 15 years		Exotic conifer	Low	Remove	407497.793	6013163.088
635	<i>Cupressus sp.</i>	Cypress	23	2.76	1.65	15x12	Semi-mature	Fair	Fair	Asymmetric	0 years	Woody weed	Exotic conifer	None	Remove	407495.157	6013156.710
636	<i>Corymbia citriodora</i>	Lemon-scented Gum	20	2.00	1.50	4x4	Semi-mature	Poor	Fair to Poor	Symmetric	0 years	Woody weed	Australian native	None	Remove	407496.897	6013156.710
637	<i>Corymbia citriodora</i>	Lemon-scented Gum	39, 18 (56.8)	4.00	2.23	15x10	Semi-mature	Fair	Poor	Symmetric	0 years	Multiple bifurcations with included bark, Woody weed	Australian native	None	Remove	407503.822	6013206.146
638	<i>Corymbia citriodora</i>	Lemon-scented Gum	22, 17, 13 (30.7)	3.68	2.09	12x10	Semi-mature	Fair	Poor	Asymmetric	0 years	Woody weed	Australian native	None	Remove	407500.330	6013206.471
640	<i>Corymbia citriodora</i>	Lemon-scented Gum	19, 18, 15, 14 (33.3)	4.00	2.17	15x12	Semi-mature	Fair	Poor	Minor asymmetry	0 years	Previously lopped, Multiple bifurcations with included bark, Woody weed	Australian native	None	Remove	407515.805	6013209.456
641	<i>Callistemon 'Kings Park Special'</i>	King's Park Special	15	2.00	1.55	4x5	Semi-mature	Fair	Poor	Minor asymmetry	5 to 15 years		Australian native	Low	Remove	407515.881	6013206.986
642	<i>Mealeuca bracteata 'Revolution Gold'</i>	Black Tea-Tree	11, 10, 10, 9.5 (20.7)	2.48	1.77	7x7	Maturing	Fair	Poor	Symmetric	1 to 5 years		Australian native	Low	Remove	407518.463	6013207.718
643	<i>Corymbia citriodora</i>	Lemon-scented Gum	26	3.12	1.95	11x9	Semi-mature	Fair	Very poor	Minor asymmetry	0 years	Previously lopped, Woody weed	Australian native	None	Remove	407521.564	6013207.265
644	<i>Phytolita serratifolia</i>	Chinese Hawthorn	15	2.00	1.55	2x2	Semi-mature	Fair	Fair to Poor	Manipulated	5 to 15 years		Exotic evergreen	Low	Remove	407514.822	6013193.402
645	<i>Phytolita serratifolia</i>	Chinese Hawthorn	15	2.00	1.55	2x2	Semi-mature	Fair	Fair to Poor	Manipulated	5 to 15 years		Exotic evergreen	Low	Remove	407515.541	6013191.649
646	<i>Phytolita serratifolia</i>	Chinese Hawthorn	15	2.00	1.55	2x2	Semi-mature	Fair	Fair to Poor	Manipulated	5 to 15 years		Exotic evergreen	Low	Remove	407517.254	6013190.778
647	<i>Phytolita serratifolia</i>	Chinese Hawthorn	15	2.00	1.55	2x2	Semi-mature	Fair	Fair to Poor	Manipulated	5 to 15 years		Exotic evergreen	Low	Remove	407519.134	6013190.015
648	<i>Syagrus romariziana</i>	Queen Palm	50	3.00	NA	9x4	Maturing	Fair to Poor	Fair	Symmetric	15 to 30 years		Palm	Low	Remove	407526.605	6013186.135
649	<i>Syningonite robusta</i>	Mexican Fan Palm	50	3.00	NA	9x4	Maturing	Fair	Fair	Symmetric	15 to 30 years		Palm	Low	Could be retained	407526.605	6013186.135
650	<i>Corymbia citriodora</i>	Lemon-scented Gum	24, 22 (23.6)	3.81	2.15	13x12	Semi-mature	Fair	Poor	Minor asymmetry	0 years	Acute primary branch attachment, Woody weed	Australian native	None	Remove	407564.830	6013158.077
651	<i>Corymbia citriodora</i>	Lemon-scented Gum	54	6.48	2.65	20x20	Semi-mature	Fair	Fair to Poor	Minor asymmetry	0 years		Australian native	None	Remove	407566.769	6013190.177

Appendix 2 Descriptors

Field name	Description
No.	Tree identification number. Unique numbers are assigned to each assessed individual tree or tree group.
Species	Identifies the tree using the international taxonomic classification system of binomial (or trinomial) nomenclature (genus, species, variety and cultivar).
Common Name	Provides the common name as occurs in current Australian horticultural literature. More than one common name can exist for a single tree species, or several species can share the same common name.
DBH (Diameter at breast height)	Indicates the trunk diameter (expressed in centimetres) of an individual tree usually measured at 1.4m above the existing ground level. Multiple stemmed trees are calculated using a formula to combine the stems into a single stem for tree protection zone calculations.
TPZ (Tree protection zone)	Tree protection zone expressed as a radial distance in metres, measured from trunk centre. Based on AS 4970
SRZ (Structural Root Zone)	Radial distance in metres measured from trunk centre to maintain tree stability - AS4970
HxW (Height x Width)	Indicates height and width of single tree and measurement generally expressed in whole metres

Age	Description
<i>Young</i>	Sapling tree and/or recently planted
<i>Semi-mature</i>	Tree rapidly increasing in size and yet to achieve expected size in situation
<i>Maturing</i>	Specimen approaching expected size in situation, with reduced incremental growth
<i>Over-mature</i>	Tree is senescent and in decline

Health	Term assigned that provides a broad description of the health and vigour of the tree.					
<u>Ratings</u>	<i>Good</i>	<i>Fair</i>	<i>Fair to Poor</i>	<i>Poor</i>	<i>Very poor</i>	<i>Dead</i>

Structure	Term assigned that provides a broad description of the structure and stability of the tree.					
<u>Ratings</u>	<i>Good</i>	<i>Fair</i>	<i>Fair to Poor</i>	<i>Poor</i>	<i>Very poor</i>	<i>Failed</i>

Form	Description
<i>Symmetric</i>	Evenly balanced crown
<i>Asymmetric</i>	Crown biased in one direction; can be minor or major
<i>Stump re-sprout</i>	Adventitious shoots originating from stump or trunk
<i>Manipulated</i>	Hedge, pollard, topiary, windrow; managed for specific landscape use or aesthetic outcome

Comment	Additional comments that provide specific detail on the condition of the tree or management requirements

Tree type	Description
<i>Indigenous</i>	Occurs naturally in the area or region of the subject site
<i>Victorian native</i>	Occurs naturally within some part of Victoria (not exclusively) but is not indigenous
<i>Australian native</i>	Occurs naturally within Australia but is not a Victorian native or indigenous
<i>Exotic deciduous</i>	Occurs outside of Australia and typically sheds its leaves during winter
<i>Exotic evergreen</i>	Occurs outside of Australia and typically holds its leaves all year round
<i>Exotic conifer</i>	Occurs outside of Australia and is classified as a gymnosperm
<i>Native conifer</i>	Occurs naturally within Australia and is classified as a gymnosperm
<i>Palm</i>	Woody monocotyledon
<i>Other</i>	Other descriptions as indicated





Retention Value	Qualitative rating provided on tree based on assessment factors. Provided as a guide for management decisions.			
<u>Ratings</u>	<i>High</i>	<i>Moderate</i>	<i>Low</i>	<i>None</i>

Recommend	Recommended action based on condition of the tree with reference to proposed site changes							
<u>Responses</u>	<i>Retain</i>	<i>Could be retained</i>	<i>Consider removal</i>	<i>Remove</i>	<i>Street tree</i>	<i>Neighbour's Tree</i>	<i>Already removed</i>	<i>Transplant</i>

Descriptors reviewed annually and subject to change

Legend



-  TPZ AS4970 Low Retention Value
-  TPZ AS4970 Moderate Retention Value
-  TPZ AS4970 High Retention Value
-  SRZ AS4970

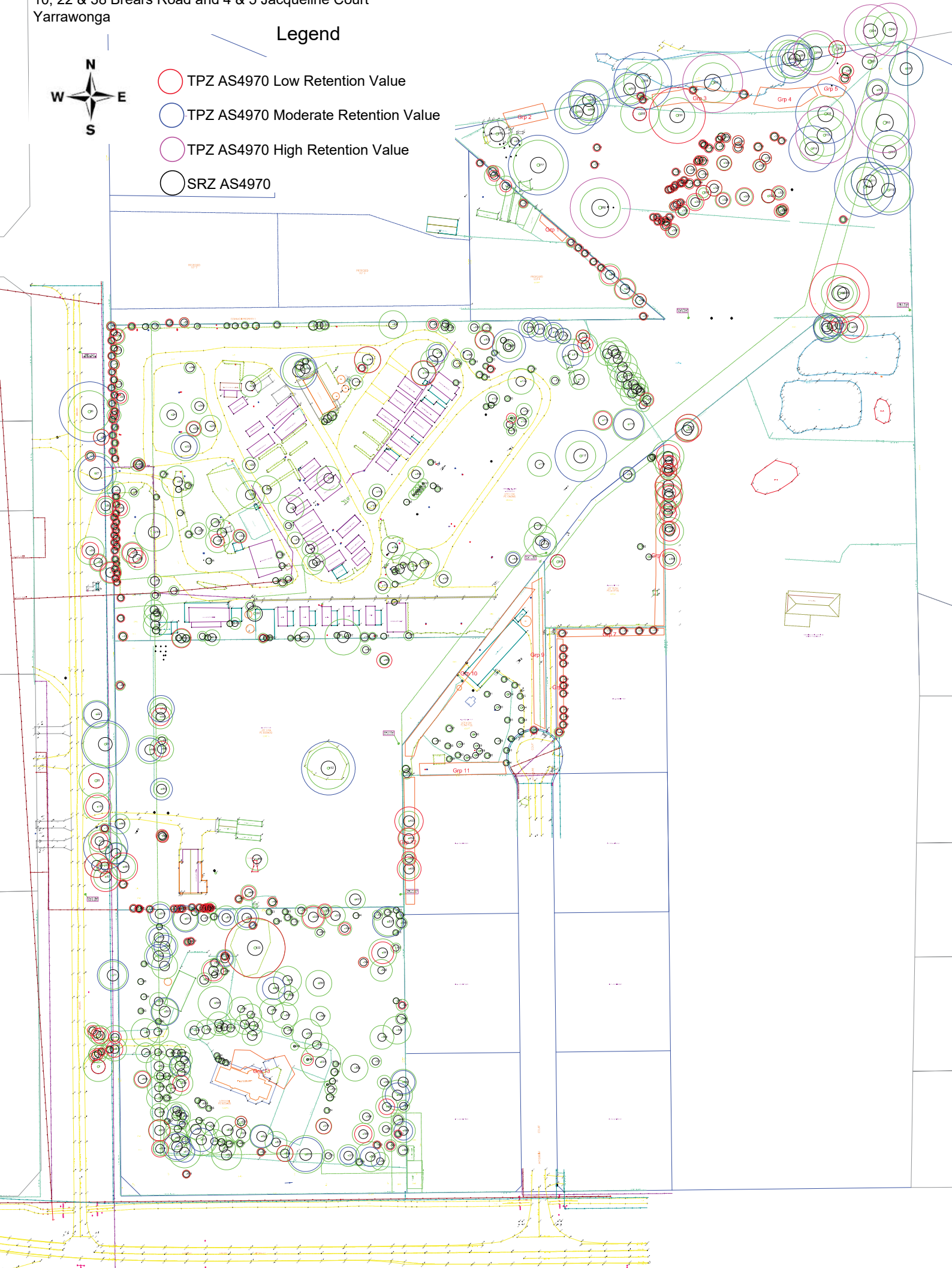

Assumptions and limiting conditions of arboricultural consultancy report

1. Any legal description provided to Treemap Arboriculture is assumed to be correct. Any titles and ownerships to any property are assumed to be correct. No responsibility is assumed for matters outside the consultant's control.
2. Treemap Arboriculture assumes that any property or project is not in violation of any applicable codes, ordinances, statutes or other local, state or federal government regulations.
3. Treemap Arboriculture has taken care to obtain all information from reliable sources. All data has been verified insofar as possible; however Treemap Arboriculture can neither guarantee nor be responsible for the accuracy of the information provided by others not directly under Treemap Arboriculture control.
4. No Treemap Arboriculture employee shall be required to give testimony or to attend court by reason of this report unless subsequent contractual arrangements are made, including payment of an additional fee for such services.
5. Loss of this report or alteration of any part of this report not undertaken by Treemap Arboriculture invalidates the entire report.
6. Possession of this report or a copy thereof does not imply right of publication or use for any purpose by anyone but the client or their directed representatives, without the prior consent of the Treemap Arboriculture.
7. This report and any values expressed herein represent the opinion of the Treemap Arboriculture consultant and the Treemap Arboriculture fee is in no way conditional upon the reporting of a specified value, a stipulated result, the occurrence of a subsequent event, nor upon any finding to be reported.
8. Sketches, diagrams, graphs and photographs in this report, being intended as visual aids, are not necessarily to scale and should not be construed as engineering or architectural drawings, reports or surveys.
9. Unless expressed otherwise: 1) Information contained in this report covers only those items that were covered in the project brief or that were examined during the assessment and reflect the condition of those items at the time of inspection; and 2) The inspection is limited to visual examination of accessible components without dissection, excavation or probing unless otherwise stipulated.
10. There is no warranty or guarantee, expressed or implied by Treemap Arboriculture, that the problems or deficiencies of the plants or site in question may not arise in the future.
11. All instructions (verbal or written) that define the scope of the report have been included in the report and all documents and other materials that the Treemap Arboriculture consultant has been instructed to consider or to take into account in preparing this report have been included or listed within the report.
12. To the writer's knowledge all facts, matter and all assumptions upon which the report proceeds have been stated within the body of the report and all opinion contained within the report have been fully researched and referenced and any such opinion not duly researched is based upon the writers experience and observations.