

# WUNGHNU & DISTRICT

---

## COMMUNITY PLAN 2022-2027

---



WUNGHNU & DISTRICT WELCOMES EWE YOU

WUNGHNU - MUNDOONA - KAARIMBA - DRUMANURE



## CONTENTS

Our District	3
Introduction to Community Planning	5
Community Voice	6
Our Demographics	7
Our History	9
Responding to Emergencies Big & Small	12
Trade Directory	13
Our Goals	14
What Our Community Said	16
Wunghnu in the Future?	18
Implementing Our Plan	21
Wunghnu & District Voice Committee	22
Acknowledgements	23
Contact Us	23

OUR DISTRICT

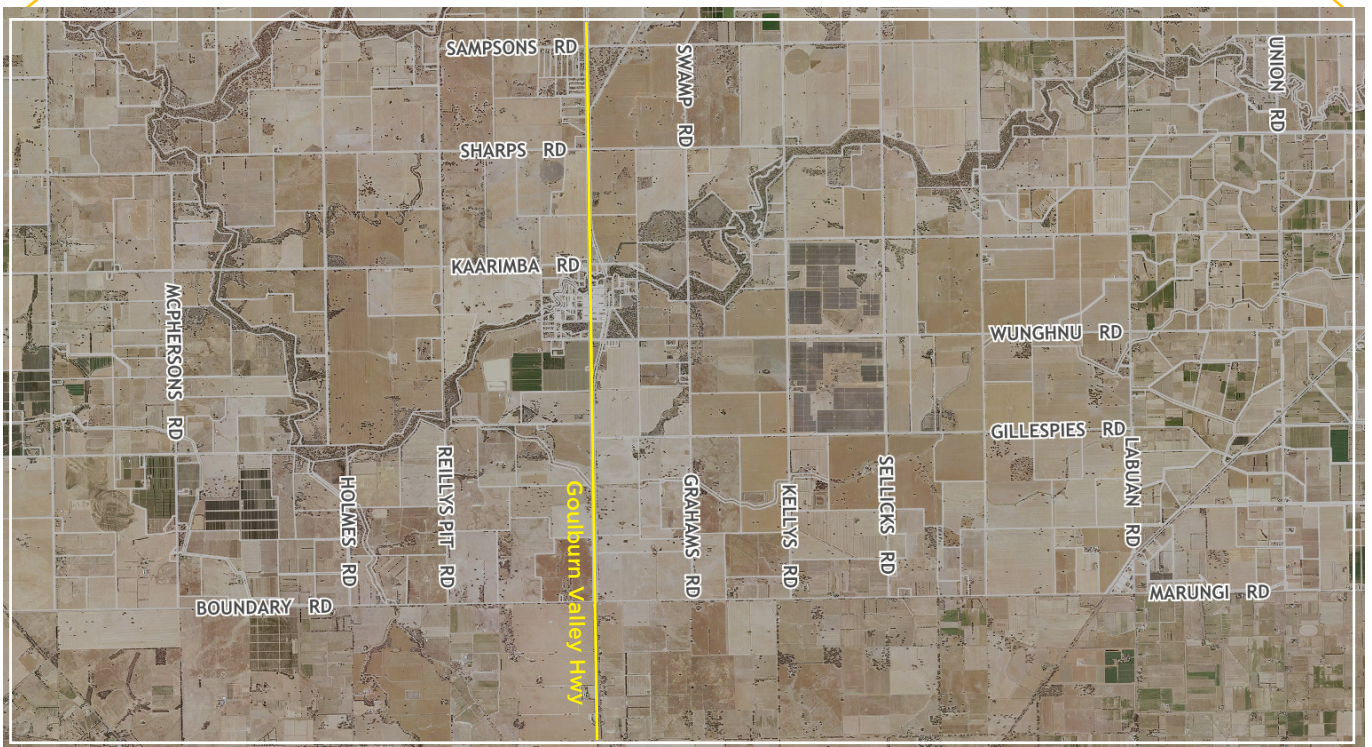



WUNGHNU TOWNSHIP





## INTRODUCTION TO COMMUNITY PLANNING

Have you ever heard someone in your community say that they'd love to see something new in town? A walking track? A mum's group? More events? A market? Have you ever wondered how many other people feel the same way?

Community Planning is about creating a safe space for you and your neighbours to discuss the future of your town, to explore all of those questions and more, and come up with ideas that will make your local area an even stronger, more beautiful, and more inclusive community.

Community Planning isn't about giving Council a wish list, though Council will take on board all of the views and opinions expressed during the process. It's about local people making sustainable change collaboratively, and making good things happen for everyone in their community.

After all, a goal without a plan is just a wish. Community Planning is about wrapping realistic strategies around everyone's hopes and dreams so that they can become a reality.





## COMMUNITY VOICE

On Sunday 24 November 2019, over 50 people joined staff from Moira Shire Council's Community Development team at a BBQ brunch to begin the conversation about creating a plan for the Wunghnu & District community.

Surveys were also distributed via the Redgum Courier, with return boxes placed at the Wunghnu Tavern and the post office. We had 5 completed surveys returned.

### What we asked:

- What do you love about Wunghnu & District, and why?
- What is your hope for Wunghnu & District's future?
- If you could choose one thing to happen in our community, what would it be?

Through the BBQ brunch and returned surveys, we not only established what participants loved about Wunghnu & District, we also started to get a sense of what could make the town and district even better.

From here, the Wunghnu & District Voice committee was formed from community members who submitted their interest to take a leading role in the development of the Community Plan. The Committee had its first official meeting in February 2020, reconvening again in March 2021 after 12 months of suspended meetings due to COVID-19.







## OUR DEMOGRAPHICS

Source: Australian Bureau of Statistics 2016 Census

### Wunghnu

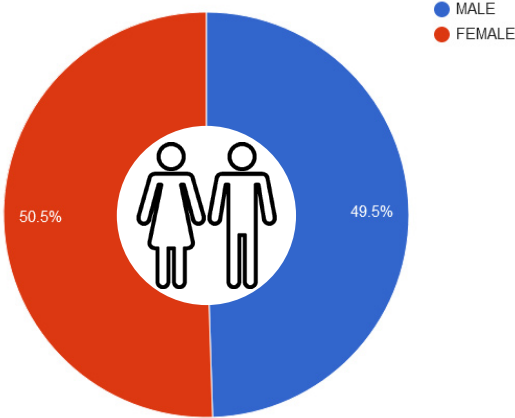
People: 334 Median Age: 44





	<b>Families:</b>	<b>84</b>
	Average children per family	2
	- for families with children	0.8
	- for all families	
	<b>All private dwellings:</b>	<b>160</b>
	Average people per household	2.2
	Median weekly household income	\$1,052
	Median monthly mortgage repayments	\$1,044
	Median weekly rent	\$210
	Average motor vehicles per dwelling	2.4

### Kaarimba

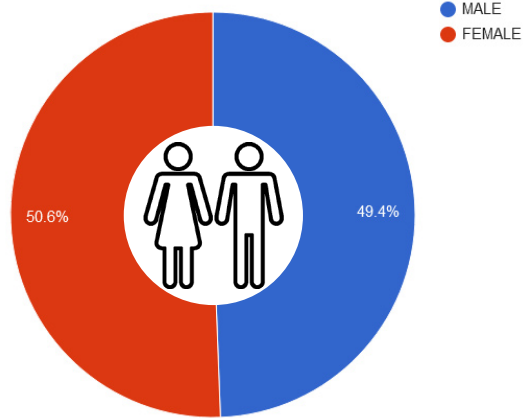
People: 85 Median Age: 46





	<b>Families:</b>	<b>28</b>
	Average children per family	1.3
	- for families with children	0.8
	- for all families	
	<b>All private dwellings:</b>	<b>39</b>
	Average people per household	2.3
	Median weekly household income	\$1,541
	Median monthly mortgage repayments	\$1,083
	Median weekly rent	\$115
	Average motor vehicles per dwelling	2.6

### Drumanure

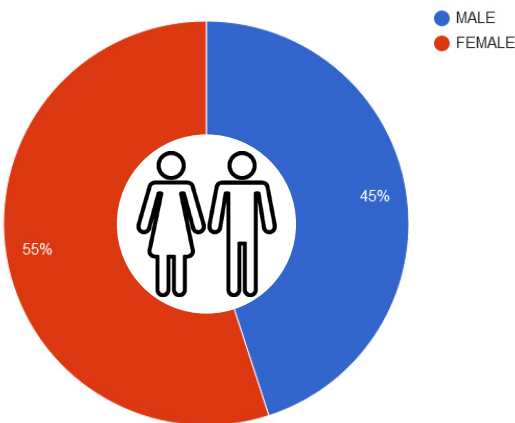
People: 41 Median Age: 37





	<b>Families:</b>	<b>9</b>
	Average children per family	1
	- for families with children	0.4
	- for all families	
	<b>All private dwellings:</b>	<b>15</b>
	Average people per household	2.3
	Median weekly household income	\$1,312
	Median monthly mortgage repayments	\$1,300
	Median weekly rent	\$0
	Average motor vehicles per dwelling	3

### Mundoona

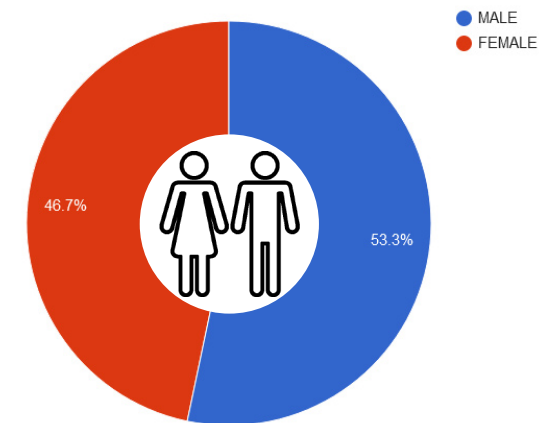
People: 119 Median Age: 47



	<b>Families:</b>	<b>33</b>
	Average children per family	1.7
	- for families with children	0.7
	- for all families	
	<b>All private dwellings:</b>	<b>49</b>
	Average people per household	2.4
	Median weekly household income	\$1,542
	Median monthly mortgage repayments	\$1,142
	Median weekly rent	\$0
	Average motor vehicles per dwelling	2.9



# OUR DEMOGRAPHICS

Source: Australian Bureau of Statistics 2016 Census

## DISTRICT

Population: 579 Median Age: 44

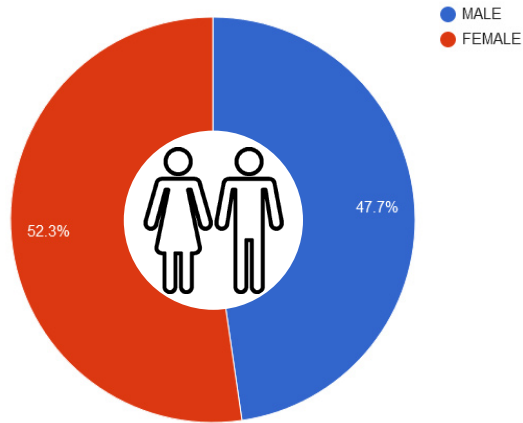

### Main Industries of Employment:

1	Agriculture / Fishing	36
2	Construction	15
3	Administration & Services Support	15
4	Health Care / Social Assistance	12
5	Manufacturing	10
6	Other Automotive Repair / Maintenance	10
7	Education & Training	9
8	Dairy Cattle Farming	8
9	Hospitals	8
10	Road Freight Transport	6
11	Wholesale / Retail / Trade	6
12	Cafe & Restaurants	5

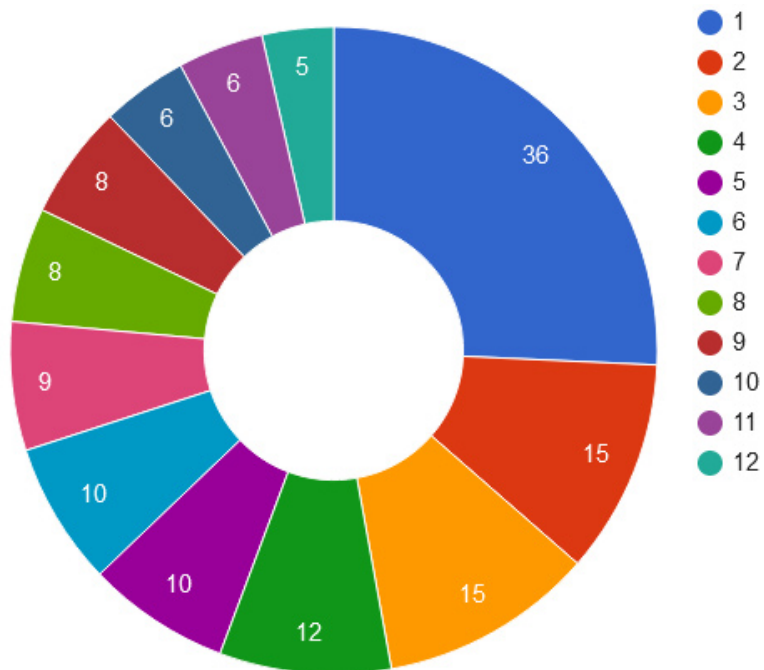

Engaged in volunteer work: 110

## OUR HISTORY

Wunghnu & District consists of the township of Wunghnu and the parish's of Drumanure, and Mundoona. First survey and selected in the early 1870's for closer settlement based primarily on 320 acre lots.

The country originally was occupied by Wandering groups of the Bangarang Aboriginal tribe, which came annually to camp east of the railway bridge at Wunghnu.



There they fished and collected water birds, eggs and chicks from the local swamps. Wunghnu's name is derived from the Aboriginal word [one yah] meaning Boomerang.

From 1840 - 1870, the area was occupied by large grazing runs manly Tallygaroopna and Katandra in the South and Strathmerton run north of the creek. Mundoona and Drumanure Parish's consisted of some excellent country to grow crops earning a reputation as producing high yielding and highly sought after produce. These communities developed amenities of their own. Drumanure opened a school in 1882 including post office, two churches and for some time a creamery. Mundoona opened two schools. Mundoona North opened 1885 near Galts Bridge and a school first called Kaarimba later renamed Mundoona opened in 1876 located in Walshes Bridge South Rd, south of Kaarimba Rd along with two churches and a creamery.



Wunghnu township began to be established [after being surveyed in 1875], developing into an important community supply and trading centre. The first store was opened by M.A. Dockery however it is hard to visualise today that it was a thriving regional centre. In its heyday, it boasted five hotels, four blacksmiths, two large and two small stores, two butchers, a saddlery, flourmill, creamery, boot maker, carpenter, two banks, a police station and post office, along with two churches.



## OUR HISTORY

The main street was lit with street lamps, being one of the earliest towns to have this luxury. A Mechanics Institute was opened in 1890 to provide services and entertainment to the growing community. Still operating today as a tavern, it is providing a similar service. Reticulated water was provided following the construction of the water tower in 1906 by Sir John Monash. The first of a number of water towers built in the region from concrete using floating forms.

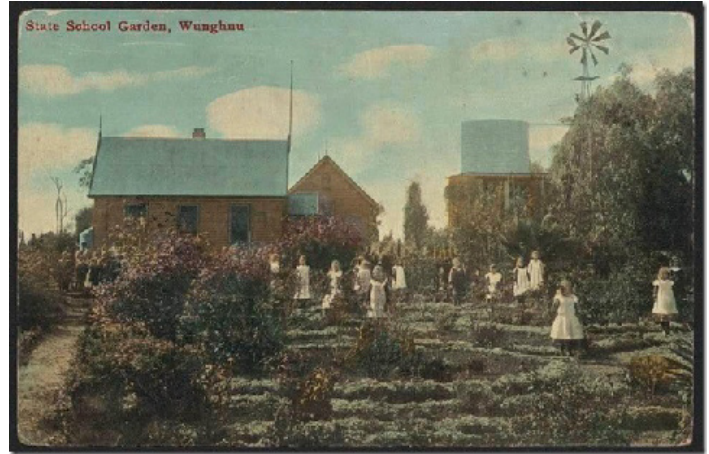

The railway came to Wunghnu in 1881 and the station grew to be an important district hub for the next 60 years. It boasted cattle and sheep trucking yards, grain terminal, goods shed, dining room, waiting room, office, as well being the land office and Court Registry for many years. Wunghnu Primary School opened in 1877, winning awards for its vegetable gardens on several occasions. Always a very sporting community over the years, Wunghnu supported a Football Club, Tennis Club, Cricket Club, and Gun Club. One of the first lawn Bowls Clubs in country Victoria was established in Wunghnu along with Croquet. Easter Monday sports started in 1897 and ran for 60 years. They included horse, bicycle and foot races and concluded with a dance in the Mechanic Institute.



Today little remains of the many grand buildings after the main street was widened in the 1950's requiring their removal. Wunghnu though is still a thriving community encompassing the school, post office/cafe, tavern [Mechanics Institute], Bowls Club, Fire Brigade, service station, as well as a wide range of businesses. The Railway Station is now closed. Football and tennis are no longer played although the Recreational Reserve is now home to a new Community Centre, Vintage Tractor Club and Moira Miniature Railway.



OUR HISTORY

Historical map of Wunghnu

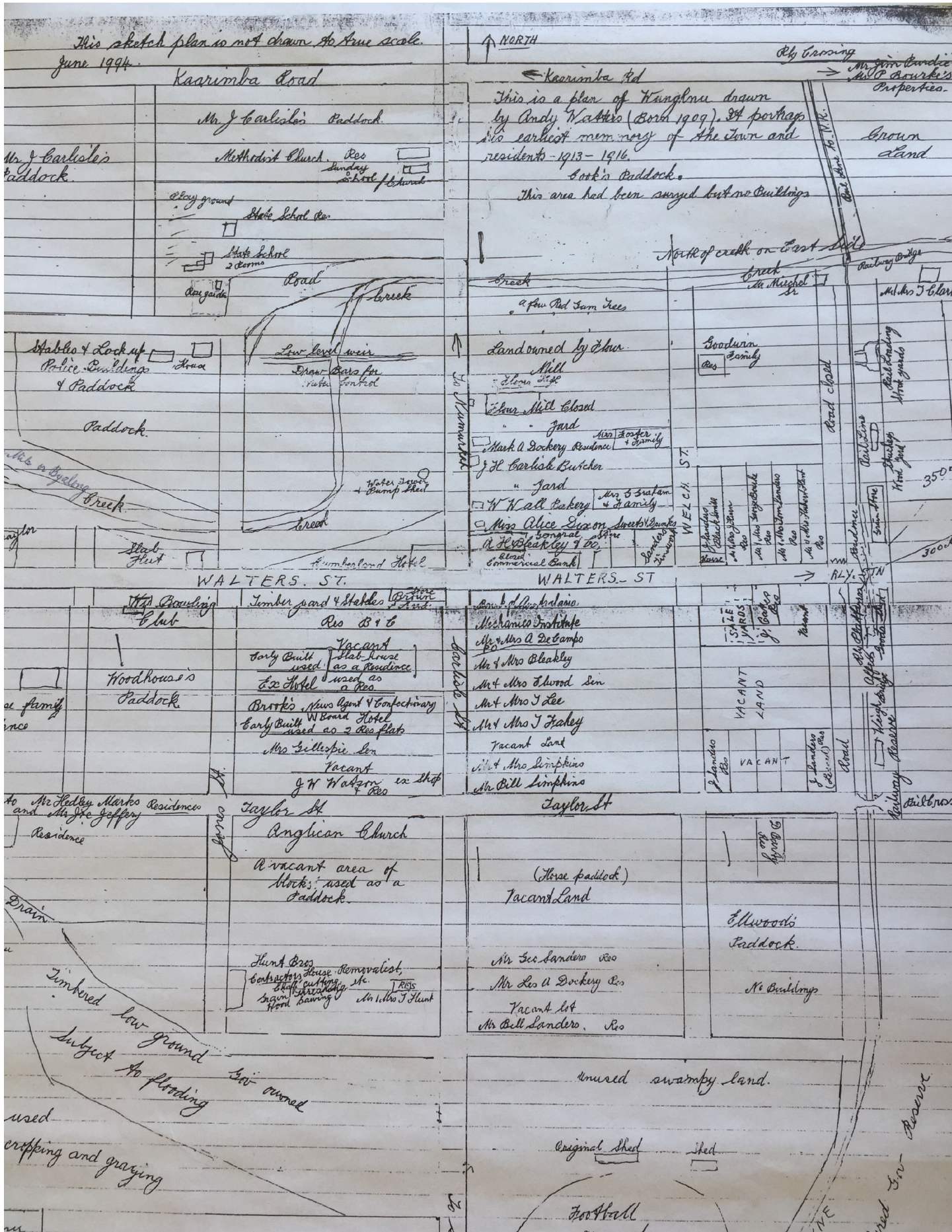



## RESPONDING TO EMERGENCIES BIG & SMALL

In the event of an emergency, information can be found from the following sources:

- One FM 98.5

**In the first instance, please call '000' and state which service is required**

**- Ambulance, Fire or Police.**

**In cases of flooding or storms, contact the State Emergency Services (SES) on 132 500**

Other contact details:

<b>POLICE</b>	Numurkah Police Station	000 / 5862 3311 19 Saxon St. Numurkah	<a href="http://www.police.vic.gov.au">www.police.vic.gov.au</a>
<b>HOSPITAL</b>	NCN Health Numurkah	5862 0555 2 Nathalia-Katamatite Rd Numurkah	<a href="http://www.ncnhealth.org.au">www.ncnhealth.org.au</a>
	GV Health	5832 2322 2-48 Graham St Shepparton	<a href="http://www.gvhealth.org.au">www.gvhealth.org.au</a>
<b>FIRE</b>	CFA	000 / 1800 226 226 (Vic Emergency Hotline) 1800 668 511 (Burn-Off Notification) 21 Taylor St, Wunghnu	<a href="http://www.cfa.vic.org.au">www.cfa.vic.org.au</a>

<b>ELECTRICITY</b>	Powercor (24hr)	132 778	<a href="http://www.powercor.com.au">www.powercor.com.au</a>
<b>GAS</b>	Elgas	131 161	<a href="http://www.elgas.com.au">www.elgas.com.au</a>
	Origin	133 574	<a href="http://www.originenergy.com.au">www.originenergy.com.au</a>
	David Walsh	5874 2246	<a href="http://www.davidwalshgas.com.au">www.davidwalshgas.com.au</a>
	AGL	135 245	<a href="http://www.agl.com.au">www.agl.com.au</a>
	BOC	131 262	<a href="http://www.boc.com.au">www.boc.com.au</a>
<b>WATER</b>	GV Water	1800 454 500 (emerg) 5831 1467 (enquiries)	<a href="http://www.gvwater.vic.gov.au">www.gvwater.vic.gov.au</a>
	GM Water	1800 064 184 (emerg) 1800 013 357 (enquiries)	<a href="http://www.g-mwater.com.au">www.g-mwater.com.au</a>
<b>ROADS</b>	Regional Roads Victoria	133 778	<a href="http://www.regionalroads.vic.gov.au">www.regionalroads.vic.gov.au</a>
<b>MOIRA SHIRE COUNCIL</b>	After Hours Emergency	5871 9222	<a href="http://www.moira.vic.gov.au">www.moira.vic.gov.au</a>

## TRADE DIRECTORY

<b>Automotive</b>	Mangles Auto Repairs	0427 348 622
	Wunghnu Service Centre	5862 1854
	Wunghnu Auto Wreckers	5862 2220
	Country Auto Service	5862 3332
	The Trim Shop	0408 366 612
	Scrivo's Auto Electrical	0417 573 235
<b>General</b>	DLR Refrigeration	0419 329 579
	Luke Mills Carpentry	0437 040 432
	Bonhams Concreting	0456 400 093
	Montgomery Transport	0418 579 474
	APC AG Contracting	0488 182 966
	Len Grass Engineering	5862 3663
	George Brown-Sheppard Engineering	0418 597 391
<b>Food &amp; Services</b>	Wunghnu Tavern	5862 2965
	Wunghnu Cafe & Post Office	5862 2028
	Powerfuel Wunghnu	5807 8729
	Longhaven Orchard	5826 9473
	Romeo's Kitchen	0481 553 874
	Sweet Treats by Sam	0490 213 927
<b>Accommodation</b>	Nine Mile House	0449 017 262



## OUR GOALS



### BUILDING OUR COMMUNITY

#### 6 Months:

- Promote and encourage attendance at Wunghnu Primary School
- Improve communication within the community (through noticeboards and/or a community newsletter)

#### 12 Months:

- Encourage community and group usage of the Wunghnu Recreation Reserve and facilities
- Establish a playgroup
- Lighting and decorations at Christmas time

#### 3 Years:

#### 5 Years:

#### Ongoing:

- Continue to foster a sense of community spirit
- Improve public perception of safety

### GROWING OUR ECONOMY

#### 6 Months:

- Become an RV Friendly town
- Establish a regular community market

#### 12 Months:

- Start a family fishing event and competition

#### 3 Years:

#### 5 Years:

- Undertake silo art to encourage tourism and become part of the silo trail

## OUR GOALS



### DEVELOPING OUR TOWN

#### 6 Months:

- Help to fundraise and obtain an electronic community safety information board
- Upgrade BBQ at George Graham Park
- Install goal posts/sporting infrastructure at the Wunghnu Recreation Reserve

#### 12 Months:

- Revitalise George Graham Park
- Increase seating in township
- Beautify the Police Paddock
- Seal power nap stops

#### 3 Years:

- Get footpaths in the main areas of the township

#### 5 Years:

#### Ongoing:

- Improve roads in townships

### PROTECTING OUR ENVIRONMENT AND HERITAGE

#### 6 Months:

#### 12 Months:

- Advocate for corella management

#### 3 Years:

- Build walking and tracks throughout the area

#### 5 Years:

- Establish a local history trail
- Implement a flood management plan

#### Ongoing:

- Protect native species that reside in the area
- Review management plans of the creek and crown land



## WHAT OUR COMMUNITY SAID

## What do you love about Wunghnu & District?

Wunghnu Cafe

New Service Station Peace & Quiet Bowling Club

Safe True Feeling of a Country Town Wunghnu Tavern

Country Living Close to Leisure Activities and Transport

Buses to Shepparton and Beyond

Scenic

## What is your hope for Wunghnu & District's future?

Indoor Toilets at Rec Reserve

RV's at the Rec Reserve

Landscape Nature Strips

Attract Young Families Keep the School

Bring the Community Closer Growth

Viability & Livability Finish Drainage Scheme Footpaths

Service Station to get Up and Running

Shop to Re-Open Remain Rural

Sporting Club

Goal Posts at the Rec Reserve

Continue to be a Good Place to Live and Visit

## WHAT OUR COMMUNITY SAID

## If you could choose one thing to happen in our community, what would it be?

Something Done on Other Side of Bridge

Upgrade BBQ at Parking Bay Community Newsletter

More Support for Local Businesses **Monthly Market**

Ground Made Available for RV's Improved Facilities

More Seats at Parking Bay **More Support for Local Attractions**

Noticeboard **Silo Art & Plaque About History** Better Community Consultation

Internal Toilets at Rec Reserve **Footpath to Post Office** Hydration Station at Parking Bay

**Open Air Movie Night During School Holidays**

Updated Artwork on Water Tank **Better Signage** Upgrade Toilets at Cemetery

Surveillance at Parking Bay **More Community Groups** LED Fire Danger Sign

**Fishing Competition at the Creek**

Seal Road to Cemetery **Activities for Youth** Review Fees at Rec Reserve

Sealed Side Road from CFA to Service Station

Information Booklet for New Residents to the Area



# WUNGHNU IN THE FUTURE?

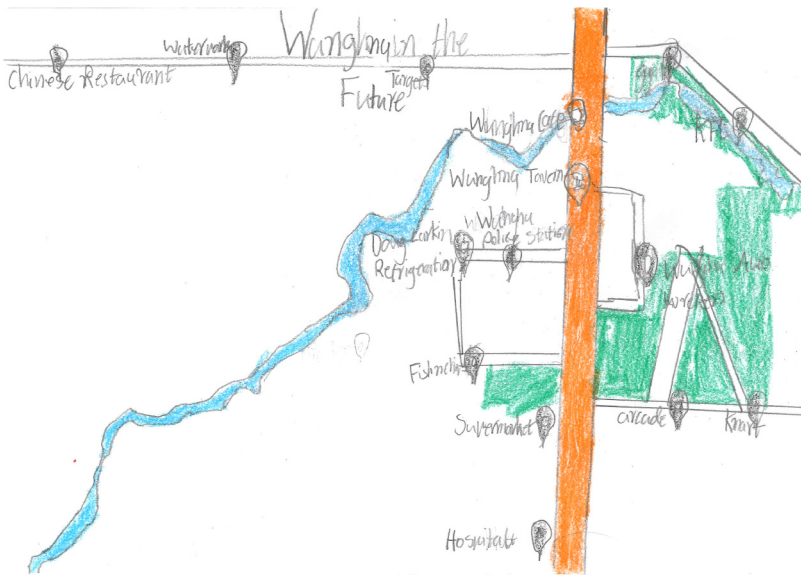

Wunghnu

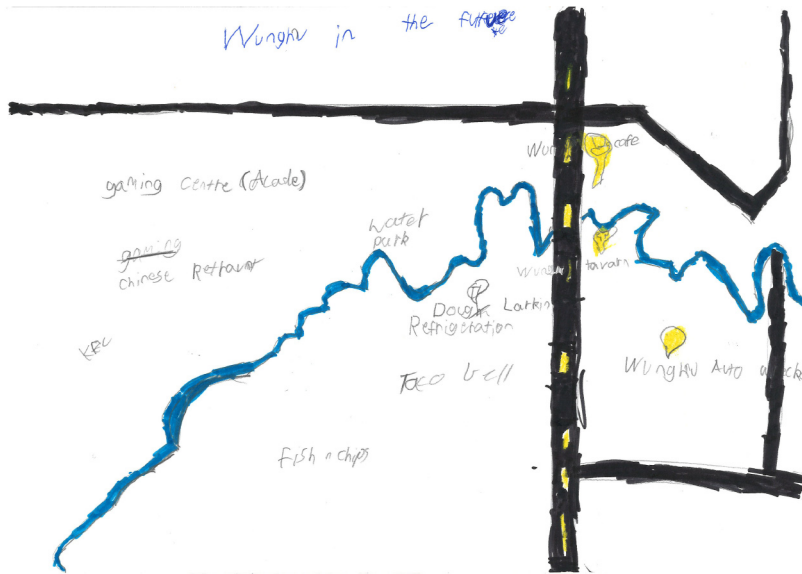
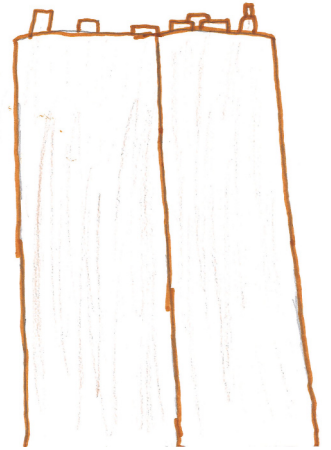

wunghnu



## WUNGHNU IN THE FUTURE...

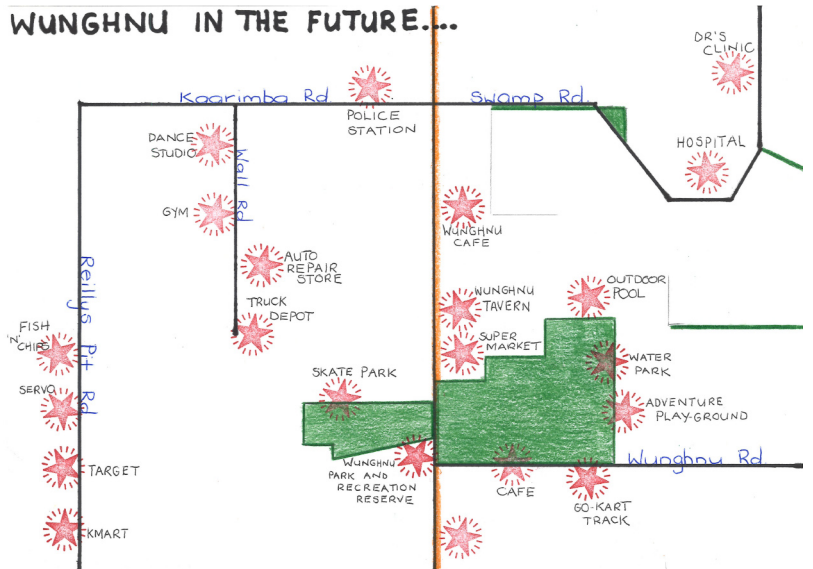

# WUNGHNU IN THE FUTURE?

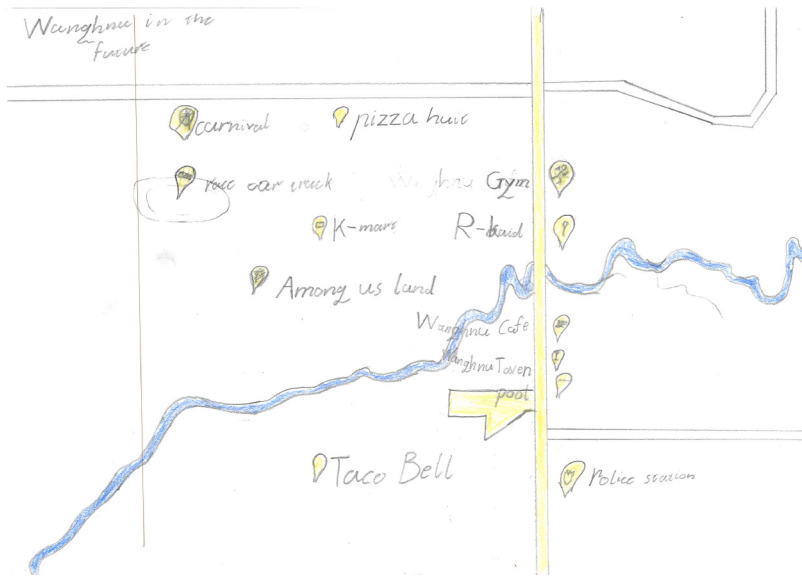



# WUNGHNU IN THE FUTURE?

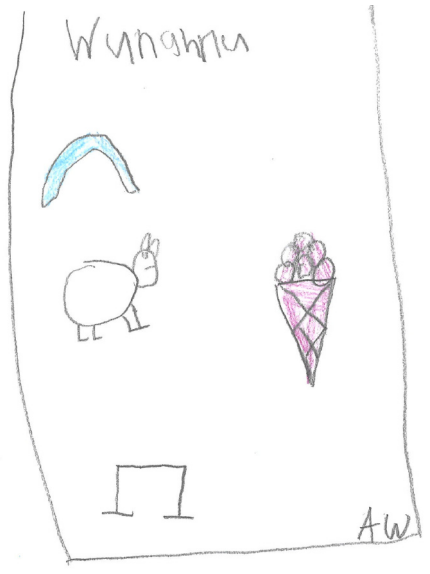
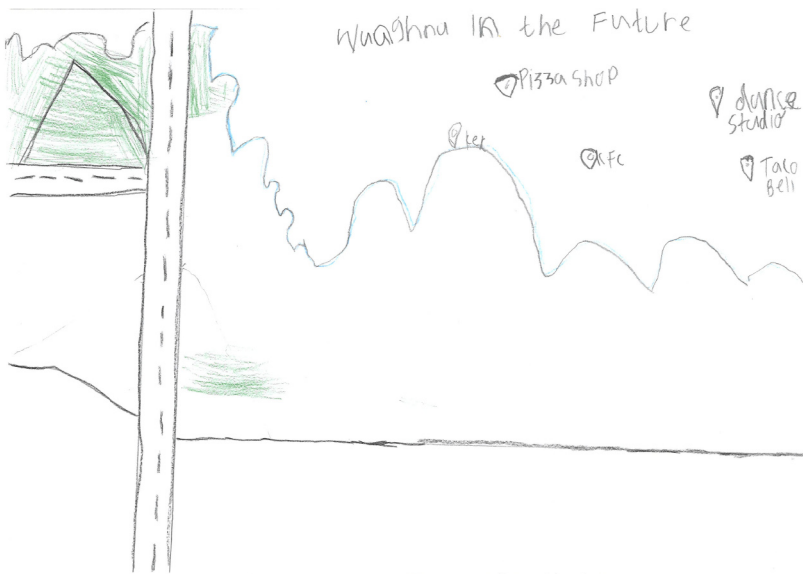
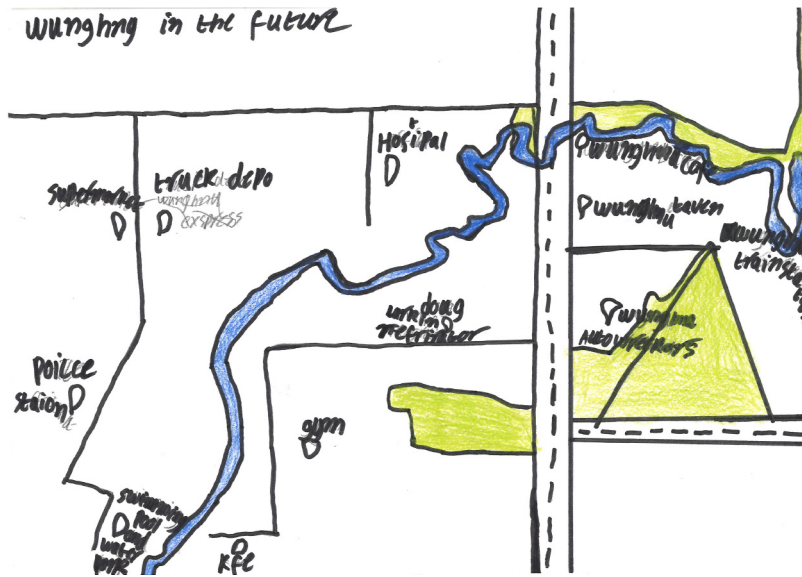

## IMPLEMENTING OUR PLAN



The Wunghnu & District Community acknowledges the importance of working together with all community, government, business and industry group stakeholders who have an interest in the content of our Community Plan to effectively achieve the goals identified.

### OUR REVIEW PROCESS

Wunghnu & District Voice will be monitoring the Community Plan through the following schedule:

#### After 6 Months:

- Monitor progress of projects
- Support and assist implementation of projects
- Call for committee members

#### After 12 Months:

- Evaluation and review of priority projects
- Completion of priority projects
- Reconsider existing projects and make new priorities
- Include newly identified projects and changing priorities
- Annual General Meeting a review of committees positions

#### After 5 Years:

- Full review of Community Plan
- Community consultation



## WUNGHNU & DISTRICT VOICE COMMITTEE



Members of the Wunghnu & District Voice Committee have volunteered many hours of their time to develop the Wunghnu & District Community Plan.

When asked why they thought community planning was important for Wunghnu & District, participants said the following:

- “To help develop the future for the younger generation and to encourage visitors in our town. I have enjoyed meeting more locals.” – Louise
- “Community planning allows community members to have input into the future of the town. It has opened lines of communication within the community.” – Pete
- “To see the town grow, develop and prosper.” – Nathan
- “It is a wonderful area to live in and I would like to keep it in good condition for future families.” – Trish
- “It is a great way to get things up and running, and I have enjoyed meeting more people.” – Beth
- “I am looking forward to building on the achievement so the past. Seeing the people in our community come together to support the future of our town and district has been great.” – Phil
- “Discussing the history, present and the future of Wunghnu and focusing on bringing out the best in Wunghnu & District that our community deserves.” – Bec
- “We are planning for a better future of our kids and environment.” – Jaci
- “Broadening the community’s awareness to keep Wunghnu & District growing, involving as many people in the community as possible. It will bring strength to the area and encourage more families” – Vikki
- “Engaging with locals to make our town and district great for future generations.” – Jennie

## ACKNOWLEDGEMENTS

### PLAN DEVELOPMENT:

We would like to thank the members of the Wunghnu & District community that have been involved in this process, whether it be through joining the Wunghnu & District Voice committee, coming along to an event, assisting with fundraising or providing feedback.

Council Support

Dana Sharp (Community Development Officer)

Graphic Design

ClubWorks (clubworks@cnl.com.au)

Photographs

Special thanks to everyone who submitted photos to be included in the Wunghnu & District Community Plan.

Drawings

A big thank you to the students and staff at Wunghnu Primary for their contribution to the Wunghnu & District Plan

### CONTACT US:

For more information regarding the Wunghnu & District Community Plan, get in touch with a Committee Member:

email us on **wunghnucomplan@gmail.com**

or like us on Facebook **Wunghnu & District Voice**

If you are interested in joining the Wunghnu & District Voice committee, please get in touch.

Beth Rogers (President) - 0432 465 493

Jennie Porter (Vice President) - 5815 5745

Jaclyn Cox (Secretary) - 0438 196 327





---

# WUNGHNU & DISTRICT

---

WUNGHNU - MUNDOONA - KAARIMBA - DRUMANURE